

## Taps & mixers; Bathing

## Ceraline

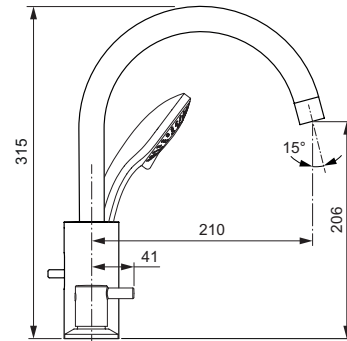

Article-No.: **BC198AA**

### Bath & shower mixer

Ceraline bath & shower rim mounted mixer, 4 holes, with ceramic valve G1/2" 90° left and right, cylindrical spout, 210mm spout projection, adaptor from G1/2" to G3/8" connection, automatic diverter, Idealrain S1 Ø80 handspray with 8lt/min flow rate, 1750mm metal double clenched shower hose, chrome.

**Colour:** AA - Chrome

#### More product details:

Type:	Bath-shower mixer
Mounting:	Rim mounted
Flow Rate (litre):	8
Net Weight (kg):	4.63
Material:	Chrome
Shape:	Curved

