

ProSys™ Installation Systems

BETTER ON
EVERY LEVEL







Ideal Standard















PART OF THE IDEAL STANDARD GROUP

ProSys™ Installation Systems

Pictograms

The symbols shown here are used throughout this brochure to indicate the following features and benefits

-  EasyFix® wall brackets
-  Tool-free servicing
-  400kg load tested
-  Dry-wall, wall-hung WC
-  Dry-wall washbasin
-  Dry-wall urinal
-  Dry-wall, wall-hung bidet
-  Dry-wall shower installation
-  Solid wall, wall-hung WC
-  Solid wall, floor-standing WC
-  Solid wall washbasin
-  Solid wall urinal
-  Solid wall, wall-hung bidet
-  Solid wall shower installation

-  Water-saving
-  Silent valve - NF class 1
-  SmartFlush
-  SmartForce
-  Mechanical actuation
-  Pneumatic actuation
-  No-touch sensor actuation
-  Infrared actuation
-  Single flush
-  Dual flush
-  Vandal-resistant
-  10 years warranty
-  5 years warranty
-  25 years spare parts availability

4	Bathrooms that work on every level
6	What you see and what you can't
8	Everything you need in one place
10	Making life better for our customers
12	Designed for performance
14	Design flexibility
16	Designed for quality and reliability
18	Designed for easy installation and maintenance
20	Efficient technology: SmartValve, SmartForce, SmartFlush
23	PROSYS™ installation systems
24	PROSYS™ installation types
26	PROSYS™ WC solutions
36	NeoX™ Sanitary Module
38	PROSYS Comfort™
40	PROSYS™ accessories
42	PROSYS™ non-WC solutions
50	Application examples
52	Flush Plates
62	Compatibility tables
64	Minimum wall thicknesses
66	Technical information

‘Whatever your bathroom vision,
it’s the details that make
the difference.’



Wall-hung bowl: Aquablade®; Strada II
 Basin: Strada II 60cm
 Fitting: Edge
 WC frame: ProSys™ 120
 Basin frame: ProSys™ deck taps



Basin: Strada II 100cm Fitting: Edge Mirror: Mirror & Light 100cm

Bathrooms that work on every level

There's more to a great bathroom design than meets the eye. What goes on behind the wall is as important as what is on or in front of the wall. Ideal Standard's range of compatible installation systems, flush plates, ceramics and fittings ensure that every layer works together. So you can configure our products not just to create a beautiful design, but one that is easy to install, hygienic, and sustainable too – a bathroom that works on every level.

What you see

Our range of flush plates offers a choice of shapes, colours, functions and materials to suit any design need, whatever your bathroom vision. They come with a choice of actuation methods and perfectly match the look and functionality of our toilet and urinal ranges.



And what you can't

R: Bidet: Strada II Bidet mixer: Edge
Frame: ProSyst™ bidet frame
L: Wall-hung bowl Aquablate®: Strada II
Frame: ProSyst™ WC frame 80 M



R: Basin: Strada II 100cm Fitting: Edge
Frame: ProSyst™ basin frame deck taps
L: Urinal: Sphero™ Maxi
Frame: ProSyst™ urinal basic frame



Our range of high-quality installation systems provide complete peace of mind behind the wall. Advanced features like our EasyFix® wall brackets, the incorporated brakes and adjustable outlet bend make our frames extremely easy to install. They have also been thoroughly tested to ensure safety, quiet operation, and reliability that lasts. Tool free-servicing means they are simple to maintain too.



Wall-hung bowl: Aquablade®; Strada II
 Flush plate: Symfo™ NT1 in black glass
 Vessel: Ipalyss® 55cm
 Furniture: Adapto console 120cm in light wood
 Vessel mixer: Edge

Everything you need in one place

Ideal Standard has always been well-known for our expertise in ceramics and fittings. With the addition of our flush plate ranges and installation systems, we can provide you with everything you need for all your bathroom projects. Whatever you are trying to achieve, we can help you complete your vision.

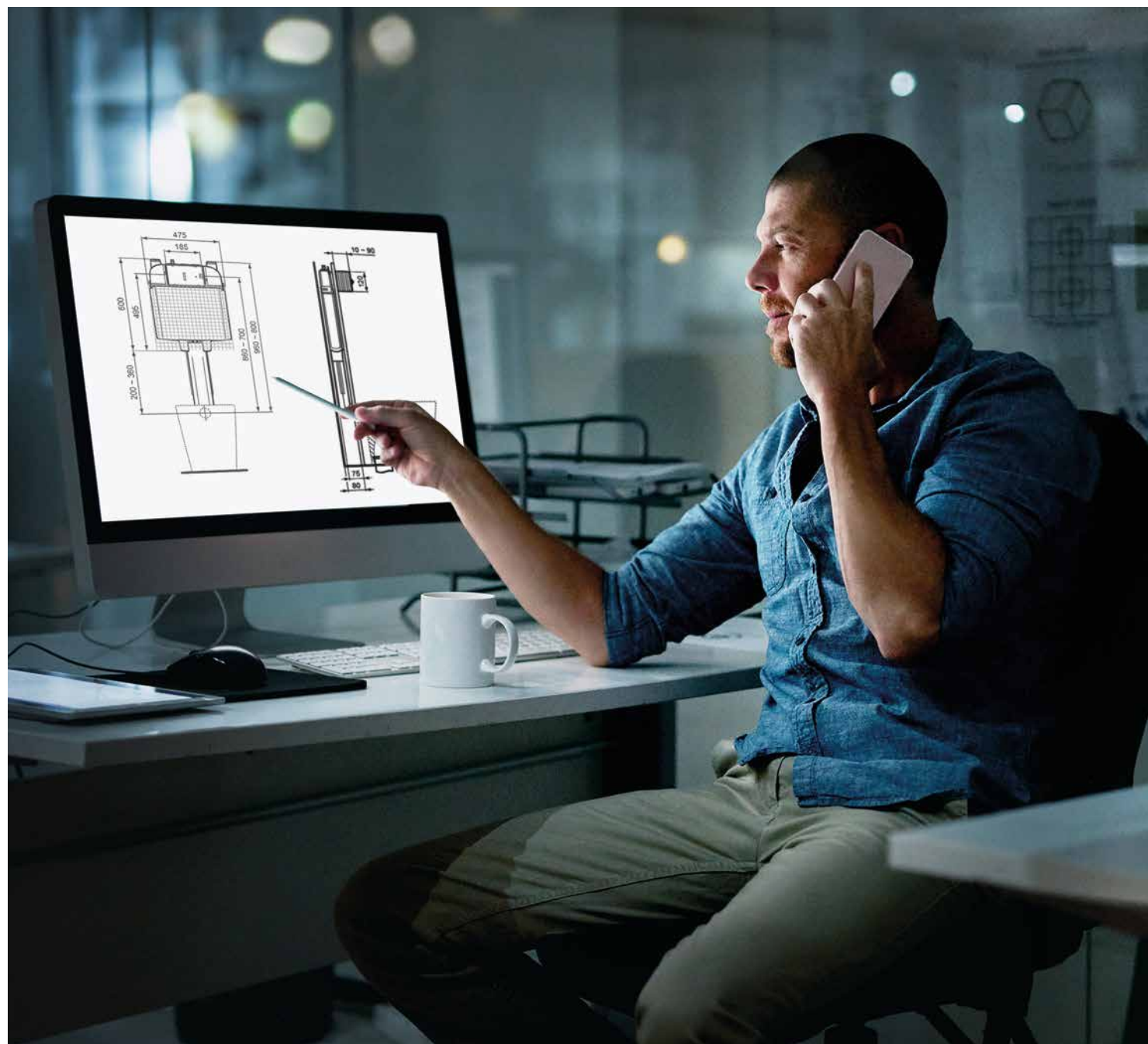

A history of expertise

We have sold over 5 million cisterns in 10 different countries in the last 50 years, which is testament to the high-quality of our products that deliver peace of mind to our customers. It's this expertise, especially in the manufacture of associated technical components, such as flush mechanisms, that we bring to our installation solutions.

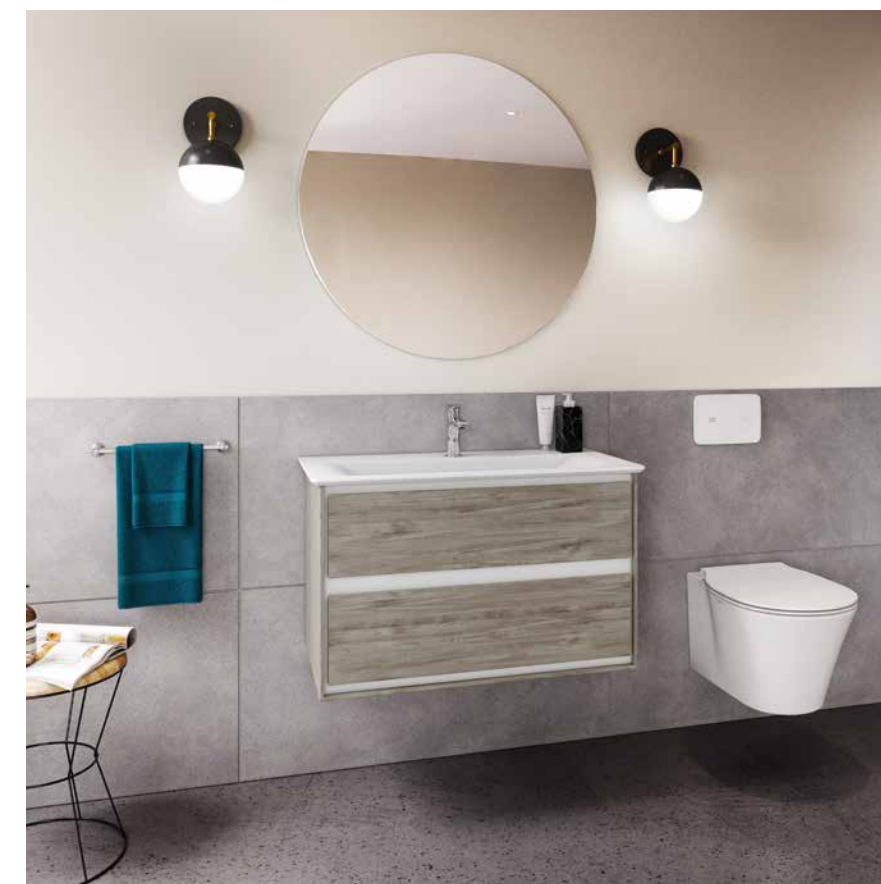

Flush plate: Altes NT1 in white
Wall-hung bowl AquaBlade®: Connect Air
Fitting: Connect Air
Vanity: Connect Air 80cm
Furniture: Connect Air basin unit 80cm

Making life better for our customers

For over 100 years, our mission has been to make life better for our customers. We do this by bringing emotional meaning to functional perfection: always innovating to anticipate the demands and aspirations of modern living.

From our roots pioneering products like the single lever tap, to delivering solutions for pressing global challenges, we create not just for today, but for tomorrow.



Flush plate: Symfo™ NT1 in white glass
 Floor-standing bowl: Connect Air
 Fitting: Connect Air
 Vanity: Connect Air 54cm
 Furniture: Connect Air basin unit 50cm



Flush plate: Altes™ NT1 in black ceramic
 Wall-hung bowl AquaBlade®: Connect Air

‘Great design is life-enhancing.
 That’s why it’s at the heart
 of everything we do.’

Designed for performance

Great design is life-enhancing. That’s why it’s at the heart of everything we do. We collaborate with award-winning designers to create elegant, contemporary and stylish bathrooms.

But it’s not just about aesthetics – we continually evaluate our materials and processes so that you can be confident in the quality of our sanitaryware, fittings, showers and furniture. And we place enormous emphasis on performance to make sure our products live up to their promises.

Whether it’s a cleaner, quieter flush, or saving water or energy, we constantly challenge ourselves to give our end users the best experience possible.

Wall-hung bowl AquaBlade®: Strada II
 Flush plate: Septa Pro™ E2 in polished chrome



Design flexibility

Whatever components your bathroom design requires, whether for new-build or renovation, we can accommodate you. Our Neox™ Sanitary module which allows renovation without having to alter an existing wall, and our ProSys™ Comfort which enables the user to vary the height of the bowl with a remote control, providing even more design flexibility.

Our installation systems come in different heights, widths and depths for dry-wall and solid wall applications. We offer solutions for WCs, bidets, basins, showers and urinals and even have optional kits to enable corner installation. Our adjustable frame

heights and free-standing models enable you to cater for specific needs. And all cisterns are equipped with silent NF Class 1 certified inlet valves, for almost silent rapid refills, which allows you to install them in new locations such as backing onto bedroom walls.

We also offer a wide range of compatible flush plates that come in a variety of designs, materials, colours and actuation types to add the finishing touch to any bathroom design.

Wall-hung bowl: Tesi
Flush plate: Oleas™ M2/ P2 in matt chrome

Wall-hung bidet: Strada II
Flush plate: Oleas™ M4 in matt chrome



Sanitary Module: NeoX™ in black
Wall-hung bowl: Connect Air

Even better with BIM

Building Information Modelling (BIM) uses intelligent, interactive 3D models to reduce errors, omissions and re-working costs during design and construction.

Ideal Standard International has one of the largest offerings of bathroom BIM models on the market, making collaboration between architects, specifiers and facilities management much easier and more productive.



Designed for quality and reliability

All of our products are thoroughly laboratory-tested during development, and undergo stress, endurance, noise and hydraulic testing. We follow strict processes of certification, including NF and WRAS, so that our customers are aware that our quality meets the highest standards.

Fire safety

All material components used by Ideal Standard to produce our cisterns are rated fire resistance class EI 120 conforming to EN 13502-2:2016.

Noise control

All our cisterns are classified to NF Class 1 – below 20dbA – which is the quietest classification and also meets the requirements of EN14124.

Acoustic results have been conducted - in accordance to EN 4109-5 - at an independent reputable sound testing laboratory and are available on request which show that our ProSys 120 cisterns are as quiet as or even quieter than many similar products in the market

European Construction Products Regulation

According to the Construction Products Regulation CPR305/2013 all cisterns sold by Ideal Standard are CE marked and produced and tested according to the harmonised product standard EN 14055.

NF certification

Our products are tested for NF certification. This is a quality and safety benchmark widely recognised in Europe.

WRAS

Our products are tested according to WRAS requirements for the design, installation, operation and maintenance of plumbing systems, water fittings and appliances that use water, to prevent misuse, waste and contamination of drinking water.

Load tests

Our WC and bidet frames are capable of holding 400kg, our urinal frames can hold 100kg, and our basin frames hold 150kg, so we can offer the right products for all projects without the need to specify specialist products.

Ideal Standard warranties are as extensive as our testing, with moving parts and tanks guaranteed for 5 years, frames for 10 years, and a reassurance that spare parts will be available for a minimum of 25 years after purchase.



'Moving parts and tanks guaranteed for 5 years, frames for 10 years, and spare parts made available for 25 years after purchase.'

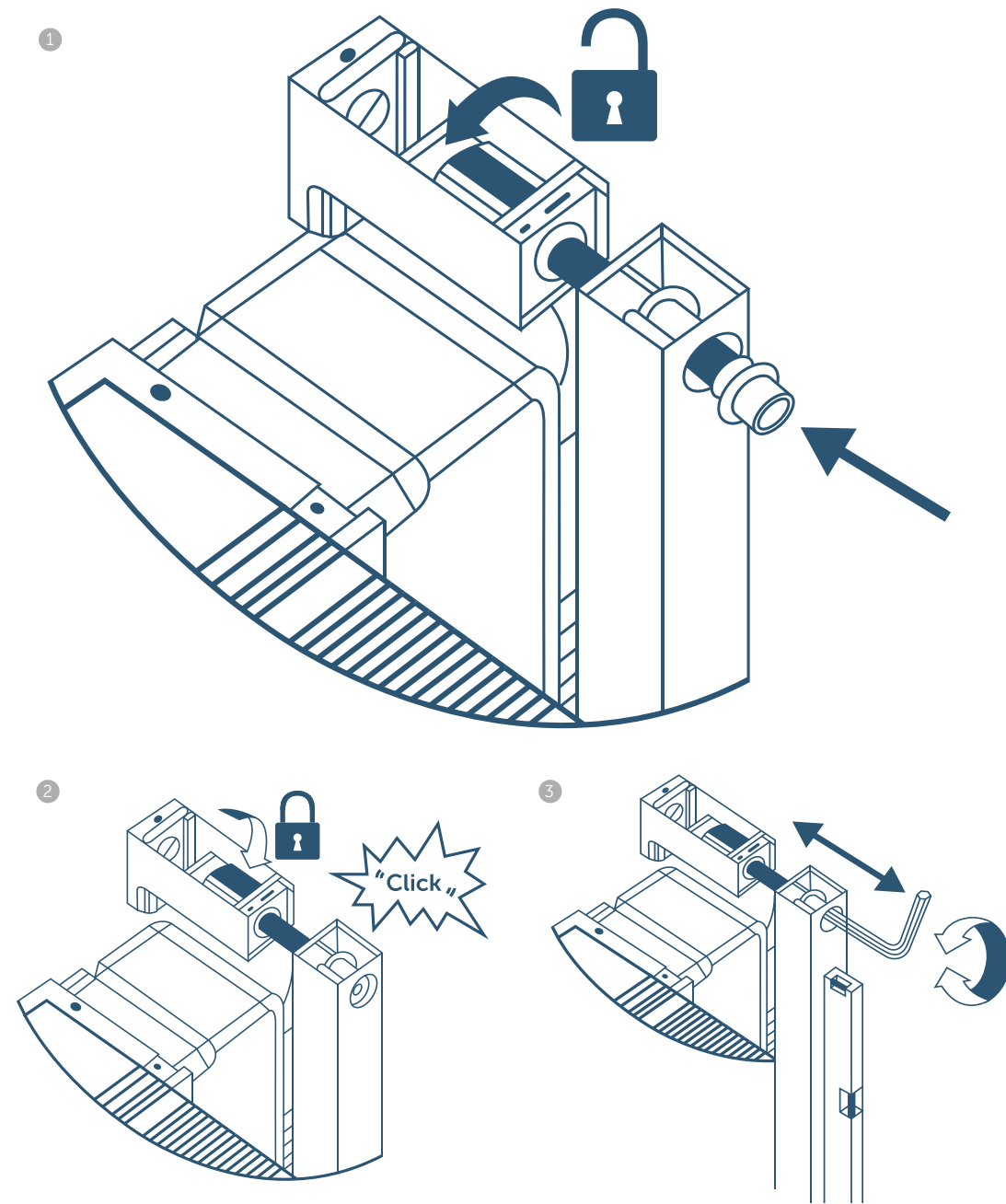

1. Insert the threaded bar into the allocated hole in the frame, and set the wall bracket dial to 'unlocked' and thread onto the bar.
2. Push the bar into the frame until it clicks and is locked in place, and set the bracket to the correct depth and rotate it to give the most suitable access for fixing to the

3. The bracket can then be fixed to the wall using the fixation pack provided, and a hex key can be used for fine adjustment to ensure the frame is perfectly level.

ProSys™ EasyFix™ wall brackets

Designed for easy installation & maintenance

At Ideal Standard, we believe that ease of installation and maintenance are just as important as reliability. That's why our frames feature EasyFix™ brackets which allow for quick fixing to the wall and precise levelling with 3 easy steps to a secure installation.

They also come with brakes on the feet so that there is no need for a second person to hold the frame when adjusting the height – making installation a one-man job. This simple height adjustment means our pre-wall systems can easily cater for different types of floor or particular customer needs. Our pre-wall systems also provide solutions for solid and dry-wall applications, as well as different bathroom fixtures.

For even more speed and flexibility, some models have different water entry options to make maintenance less time-consuming, no special tools are required and some cisterns feature a one-piece cover plate for easy access when parts need to be replaced.

We've made adjusting flush volume easier and faster as well – it can be done pre- or post-installation by simply adjusting the outlet valve.

Our cisterns can be operated with electronic, mechanical or pneumatic flush plates to suit users' requirements.



'We believe that ease of installation and maintenance are just as important as reliability.'

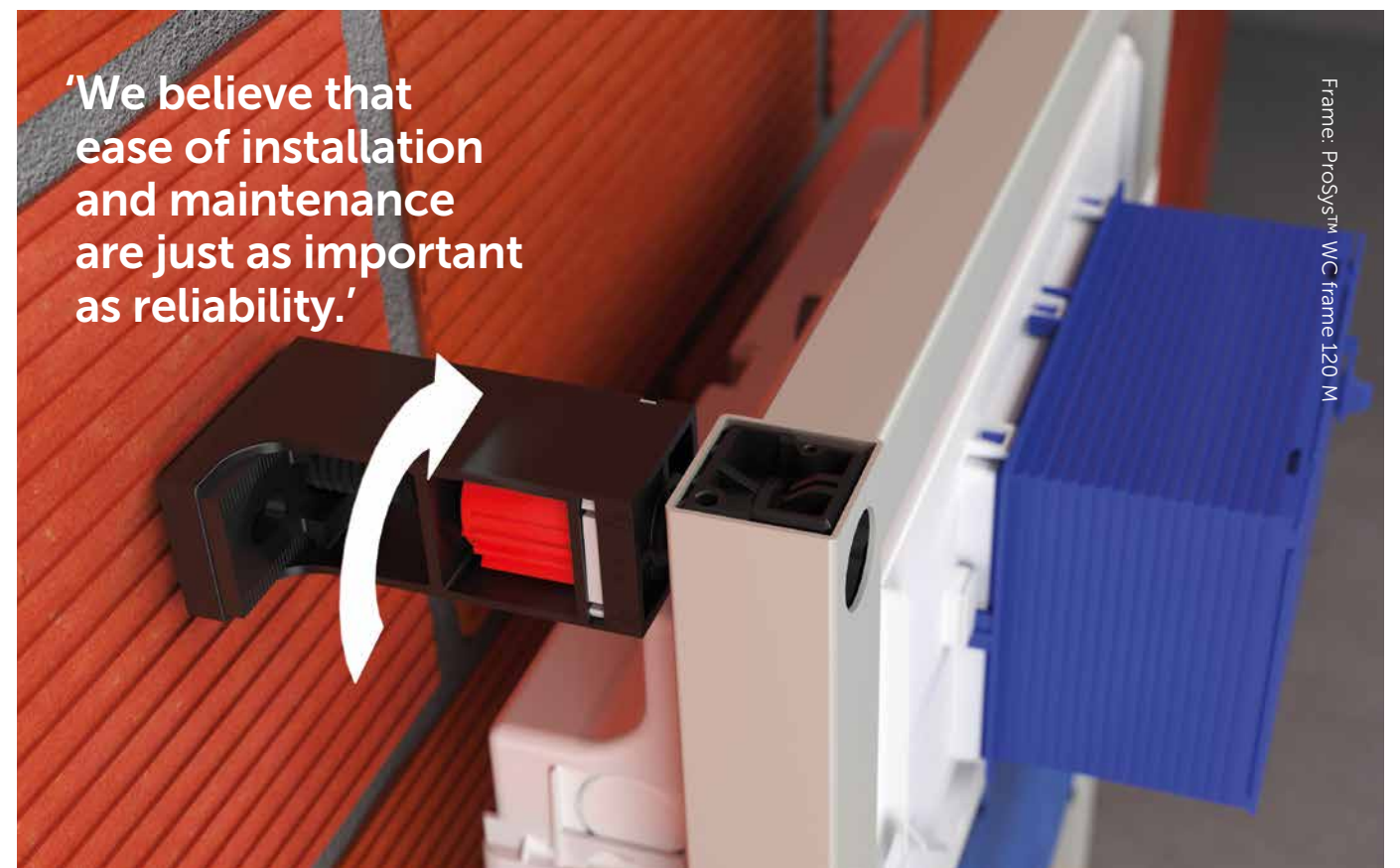

Frame: ProSys™ WC frame 120 M

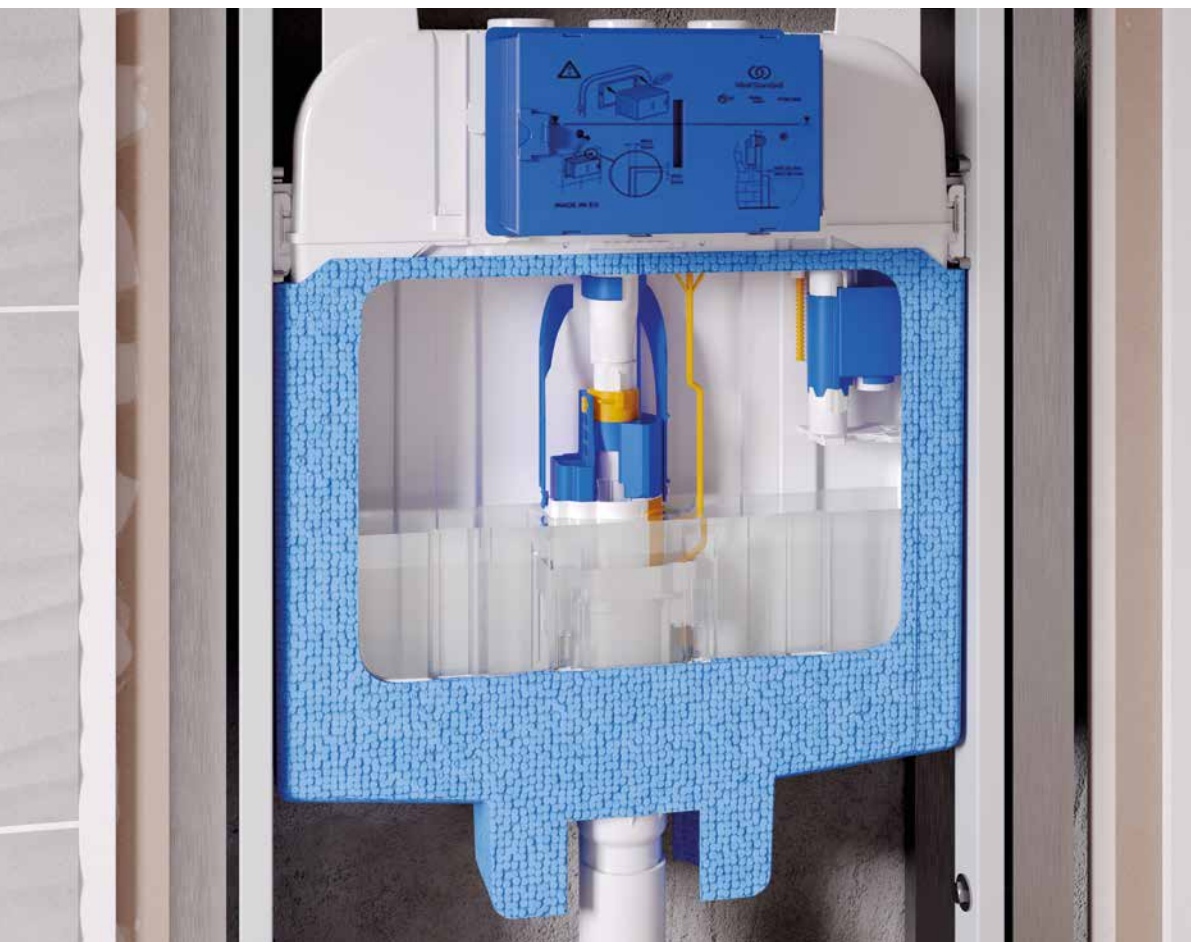

Frame: ProSys™ WC Frame 120 M

Wall-hung bowl AquaBlade®: Connect Air
Flush plate: Oleas™ M1/ P1 in chrome



SmartValve saves water



Standard on all ProSys™ cisterns, this innovative inlet valve only allows refilling of the cistern after the flush is complete, avoiding any wastage of water during flushing. This patented feature has been proven to save up to 63 litres a week, which corresponds to a 12% reduction* in users' water bills. Not only does it promote water conservation, it is also so quiet it has been certified by NF as acoustic Class 1. It is a quick-filling valve and is compatible with any water pressure.

*When comparing average use in a single-family dwelling of 4 people.

'Save up to 63 litres a week, which corresponds to a 12% cost reduction in water bills.'

SmartFlush improves hygiene



A self-contained system within the cistern that dispenses liquid detergent with every flush. In contrast to traditional tablets, which are always in contact with water, and might damage the cistern and its components, the sanitising liquid is stored in a separate container inside the cistern and delivers a small dose with every flush directly into the flush pipe to mix with water and clean the WC bowl.

The SmartFlush system is compatible with all Ideal Standard cisterns and with selected models in the Oleas™ flush plate range. It is fast and easy to refill and can use any liquid WC disinfectants (we recommended chlorine-free liquid detergents with a viscosity between 150 and 300cp at 20°C).

- Hygiene and cleanliness with every flush
- Storage capacity of 450ml, sufficient for approximately 200 flushes
- Controlled dosage: 2ml per flush
- Fast and easy to refill – simply push the flush plate to the side, pull out the nozzle and refill the container, then close the flush plate.

SmartForce creates its own energy



Frame: ProSys™ WC Frame 120 M



This technology harnesses the power of flowing water to generate enough energy* to power a no-touch control plate. It does not require a connection to an electrical power source** or the replacement of batteries. The system is available for our dual flush Symfo™ and Altes™ control plates, which only require the approach

of a hand to activate the flush, making them ultra-hygienic.

SmartForce is ideal for bathrooms that are regularly used, but even in very low-usage environments, the battery can be easily recharged with the charger provided.

Tests have shown the following typical performance

Flushes per day	Required charges (within 2 years)
0	5
5	4
10	3
15	2
20	1
25	0

*Compatible with all ProSys™ 120 and ProSys™ 80 cisterns

**Please note that the presence of a high percentage of lime-scale in the water may cause obstructions in the hydroelectric generator, leading to malfunction.

How it works

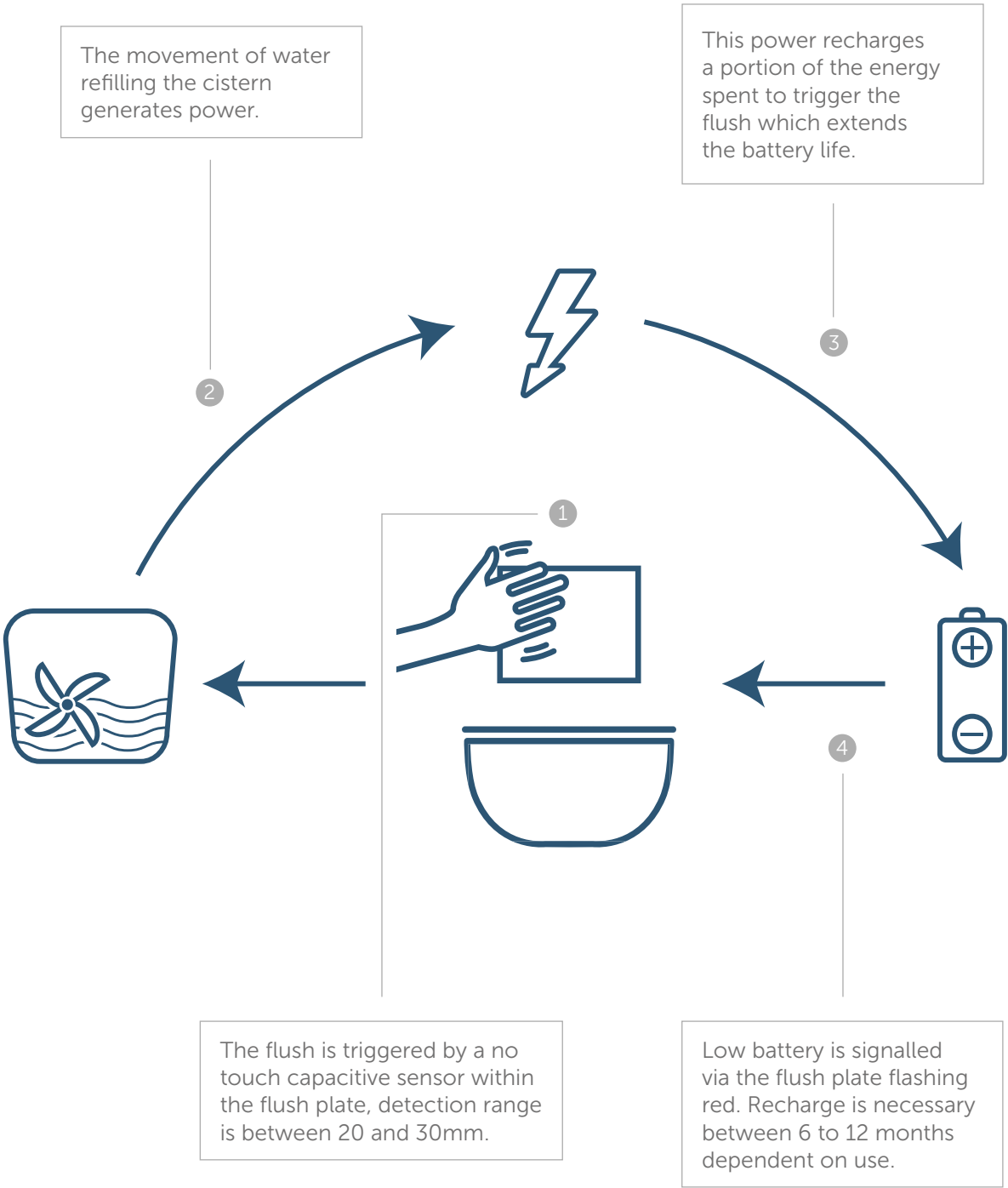

Concealed cisterns

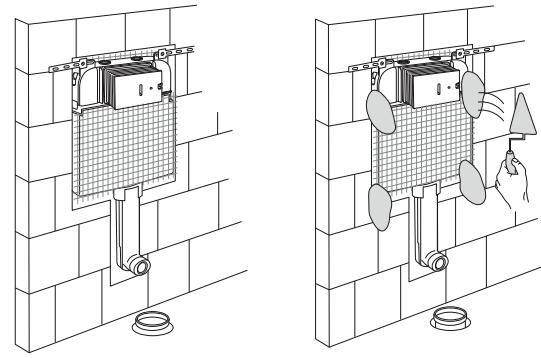

Light frames/encapsulated

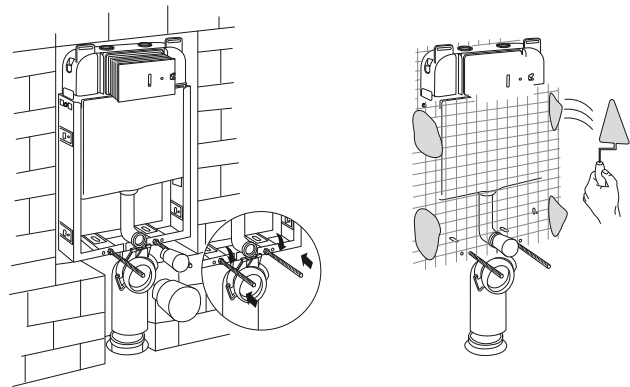

Frames

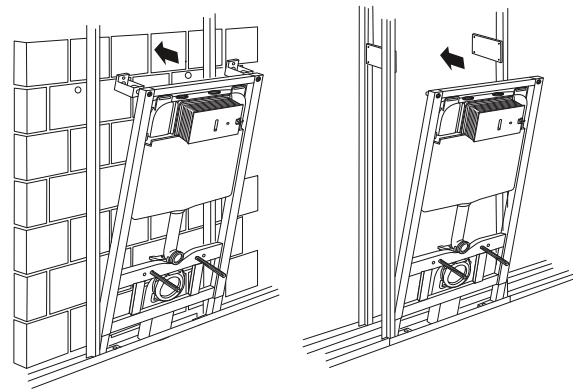

Freestanding frames

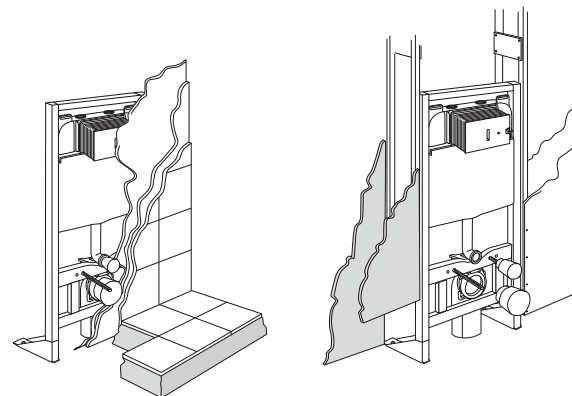

Pre-wall installation types

Concealed cisterns

This wall installation system should be selected when installing the cistern in a solid wall that will be brick-lined with a floor-standing toilet.

Light frames /encapsulated

This wall installation system should be selected when installing the cistern in a solid wall that will be brick lined with a wall-hung toilet.

Frames

This installation system can be used in dry-wall applications as well as solid wall applications. The main advantage of the system is the ease and speed of safely installing a cistern with a wall-hung toilet.

Freestanding frames

Our freestanding frames are used in dry-wall applications with a wall-hung toilet. The main advantage of the system is the ease and speed of safely installing a concealed cistern with a wall-hung toilet without the need of any type of structural or load-bearing brick wall.



Wall-hung bowl: Esedra
Flush plate: Solea™ P2 in white

ProSys™ – benefits at a glance

Tool-free maintenance
It's quick and easy to access the cistern

Corrosion resistant frame
For complete peace of mind behind the wall

Load tested up to 400kg for WC and Bidet frames
Washbasin frames support up to 150kg, urinal frames up to 100kg

Adjustable outlet bend
Enables an easy and flexible depth adjustment to conveniently fit all waste pipe arrangements

Simple Height adjustment from 0-200mm
Brakes on feet make height adjustment a simple, one-man job*

Fast and easy installation
EasyFix™ brackets allow for fast fixing to the wall and precise levelling of the frame in 3 easy steps

Water-saving SmartValve
All ProSys™ cisterns are fitted with a special delayed-fill inlet valve which can save up to 9 litres of water per day. Water only begins to fill the cistern after the flush valve is closed

Fully adaptable service box
Depth is adjustable from 20 to 90mm, which allows the service box to cover all wall thicknesses. The box is made from polypropylene, which is soft and easy to cut

Adjust dual flush volume
Changed manually on the outlet valve, with no need to change the inlet valve

* Available for ProSys™ 120, ProSys™ 150 and bidet frames

Frame: ProSys™ WC frame 120 M

ProSys™

WC solutions

ProSys™ 120

Easy to install and maintain

- Tool free maintenance with access through the service tunnel assessed by removing the flush plate or inspection plate where a flush plate is positioned remotely
- Easier installation thanks to our EasyFix® wall brackets
- Incorporated in-cistern stop valve allows for the water supply to be turned off prior to replacing the inlet valve or outlet valve seals

SmartValve

- Exclusive water-saving inlet valve delays refill until flush valve is closed
- Silent – Class 1 NF certified

Outlet valve

- Dual flush, pre-set for 6/3 litres
- Single operation to adjust flush volumes to 4.5/2.6L litres

Compatible kits

- SmartFlush kit – R018667
- Pneumatic conversion kit – R009867
- Electronic conversion kit – sensor – R015867
- Electronic conversion kit – infrared – R009967
- SmartForce kit – R015767

Flush plate compatibility

Mechanical

- Oleas M1, M2, M3, M4
- Solea M1, M2
- Septa Pro M1, M2

Pneumatic with ProSys™ Conversion Kit 120P

- Oleas P1, P2, P3
- Solea P1, P2
- Septa Pro P1, P2, P3, P4, P5
- Septa XS P1, P2
- Septa Pro Floor

Electronic with ProSys™ Conversion Kit 120NTS

- Symfo NT1
- Altes NT1

Electronic with ProSys™ Conversion Kit 120NT IR

- Septa Pro E1, E2



ProSys™ WC cistern 120 M – R015667

- Flush cistern to be installed inside a solid wall
- Compatible with all floor-standing WC bowls (separate floor brackets also allow for installation with wall-hung WC bowls)
- Mechanical actuation



ProSys™ WC light frame 120 M – R009767

- Encapsulated tank to recess
- For better sound insulation in masonry walls
- Compatible with all wall-hung WC bowls
- Mechanical actuation

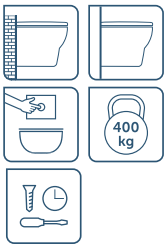

ProSys™ WC frame 120 M – R009467

- Installation in support on masonry wall resistant to the load of the bowl; minimum 26mm of drywall or plasterboard 50mm
- Compatible with all wall-hung WC bowls
- Mechanical actuation
- Height adjustable from 0 to 200 mm

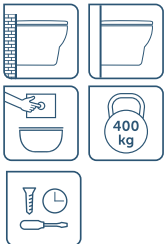

ProSys™ WC frame 120 M 3 heights – R009567

- Installation in support on masonry wall resistant to the load of the bowl; minimum 26mm of drywall or plasterboard 50mm
- Allows adjustment of the fixing height of the bowl; choice of 3 heights before closing the partition: 320/370/420 mm
- Compatible with all wall-hung WC bowls
- Mechanical actuation
- Height adjustable from 0 to 200 mm

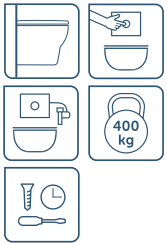

ProSys™ WC frame Freestanding 120 M – R015467 and 120 P R009667

- Freestanding system for plasterboard wall applications where there is no solid wall to secure the frame to (i.e. fixed to the floor only)
- Compatible with all wall-hung WC bowls
- Models for mechanical or pneumatic actuation
- Height adjustable from 0 to 200 mm

ProSys™ WC solutions

ProSys™ 80

The versatile solution for slim installations

- Tool free maintenance with access through the service tunnel assessed by removing the flush plate or inspection plate where a flush plate is positioned remotely
- Incorporated in-cistern stop valve allows for the water supply to be turned off prior to replacing the inlet valve or outlet valve seals

Outlet valve

- Dual flush, pre-set for 6/3 litres
- Two-step operation to adjust flush volumes to 4.5/3 litres

SmartValve

- Exclusive water-saving inlet valve delays refill until flush valve is closed
- Silent – Class 1 NF certified

Compatible kits

- SmartFlush kit – R018667
- Pneumatic conversion kit – R014967
- Electronic conversion kit – sensor – R015067
- Electronic conversion kit – infrared – R015167
- SmartForce kit – R019167
- ProSys™ flush valve for wc frame 80m – RV15167

Flush plate compatibility

Mechanical

- Oleas M1, M2, M3, M4
- Solea M1, M2
- Septa Pro M1, M2

Pneumatic with ProSys™ Conversion Kit 80P

- Oleas P1, P2, P3
- Solea P1, P2
- Septa Pro P1, P2, P3, P4, P5
- Septa XS P1, P2
- Septa Pro Floor

Electronic with ProSys™ Conversion Kit 80NTS

- Symfo NT1
- Altes NT1

Electronic with ProSys™ Conversion Kit 80NTS IR

- Septa Pro E1, E2



ProSys™ WC cistern 80 M - R014767

- Flush cistern to be installed inside a solid wall
- Compatible with all floor-standing WC bowls
- Mechanical actuation



ProSys™ WC light frame 80 M - R014667

- For setting into masonry walls
- Compatible with all wall-hung WC bowls
- Mechanical actuation

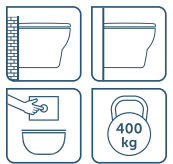

ProSys™ WC frame 80 M - R014367

- For installation in front of masonry wall, finish with plasterboard
- Compatible with all wall-hung WC bowls
- Mechanical actuation
- Adjustable height from 0 to 150mm

ProSys™ WC solutions

ProSys™ 150

The perfect solution for low-height applications

- Tool free maintenance with access through the service tunnel assessed by removing the flush plate or inspection plate where a flush plate is positioned remotely
- Incorporated in-cistern stop valve allows for the water supply to be turned off prior to replacing the inlet valve or outlet valve seals
- Features multiple water connections and gives a choice of top or front actuation

Outlet valve

- Dual flush, pre-set for 6/3 litres
- Single operation to adjust flush volume to 4.5/3 litres
- EPDM seal

SmartValve

- Exclusive water-saving inlet valve with delayed refill system
- Silent – Class 1 NF Certified

Compatible kits

- SmartFlush kit – R018667
- Pneumatic conversion kit – R009267
- Conversion kit for top actuation (for Oleas flush plates) – R017667

Flush plate compatibility

Mechanical – Front Actuation

- Oleas M1, M2, M3, M4
- Solea M1, M2
- Septa Pro M1, M2

Mechanical –Top Actuation

- Solea M1, M2
- Septa Pro M1, M2

Mechanical with ProSys Conversion Kit 150 MT - Top Actuation

- Oleas M1, M2, M3, M4

Pneumatic with ProSys™ Conversion Kit 150P - Front and Top Actuation

- Oleas P1, P2, P3
- Solea P1, P2
- Septa Pro P1, P2, P3, P4, P5
- Septa XS P1, P2



ProSys™ WC cistern 150 M - R014167

- Flush cistern to be installed inside a solid wall
- Compatible with all floor-standing WC bowls
- Mechanical top or front actuation

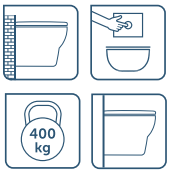

ProSys™ WC frame 150 M - R009067

- Installation to masonry wall resistant to the load of the bowl, with plasterboard-finished wall
- For drywall and partial height wall construction
- Compatible with all wall-hung WC bowls
- Mechanical front or top actuation
- Height adjustable from 0 to 200 mm

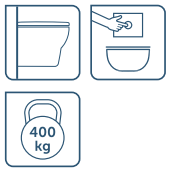

ProSys™ WC frame freestanding 150 M - R009167

- Freestanding system for plasterboard wall applications where there is no solid wall to secure the frame to (i.e. fixed to the floor only)
- For drywall and partial height wall construction
- Compatible with all wall-hung WC bowls
- Mechanical front or top actuation
- Height adjustable from 0 to 200 mm

ProSys™ WC solutions

WC Half frames

If you already have a concealed cistern, these frames allow you to replace a floor-standing toilet with a wall-hung one. So it's possible to renovate without removing the cistern. Like our other WC frames, our half frames are corrosion-resistant and load tested up to 400kg.



WC half frame - R010067

- Compatible with all wall-hung WC bowls
- 2 fixation points for WC
- Pre-assembled tubular frame for built-in or plasterboard wall installation
- Quick and easy installation
- Height-adjustable from 0 to 200mm
- Depth-adjustable outlet bend



WC half frame freestanding - R010167

- Compatible with all wall-hung WC bowls
- 2 fixation points for WC
- Pre-assembled tubular frame for plasterboard wall installation where there is no solid wall to secure the frame to (i.e. fixed to the floor only)
- Quick and easy installation
- Height-adjustable from 0 to 200mm
- Depth-adjustable outlet bend



Wall-hung bowl: Connect
Flush plate: Oleas™ M3/ P3 in matt chrome

NeoX™ Sanitary Module



Wall-hung WC: AquaBlade® Strada II
Sanitary module: NeoX™
Vessel: Strada II
Vessel mixer: Edge
Furniture: Adapto



A universal solution for a quick and easy bathroom renovation. All the technology is hidden inside the module so you don't have to alter an existing wall. Installation is fast and simple because the existing water connections can be used.

NeoX™ redefines the concept of concealed cisterns. With its small dimensions, sophisticated design and the advanced technology such as the water-saving SmartValve housed within, it is the ideal solution for both new and renovated bathrooms. The simple, modern design will fit into any bathroom. To activate the flush, simply press the matt, stainless steel tilt selector button. NeoX™ is available in black or white tempered glass outlined with an elegant, one-piece, brushed stainless steel frame.

NeoX™ Sanitary Module Black - R0144A6 White - R0144AC

- Compatible with all wall-hung WC bowls
- 6mm tempered glass front panel (split into two parts for easy maintenance)
- Four external water entry positions and one back entry position available
- 108mm deep
- Pneumatic actuation

ProSys Comfort™



ProSys Comfort™ allows the user to vary the height of a toilet using a remote control, which makes it suitable for children, the elderly and also to assist with the transfer of people with reduced mobility.

The ProSys Comfort™ frame is compatible with all wall-hung WC bowls and enables a height adjustment of 150mm, with almost silent operation. The powerful motor exerts a lifting force of 400kg, altering the height at 28mm per second, so adjustment is quick and easy. ProSys Comfort™ is available in black glass and compatible with a wide variety of flush plates*, so it is both highly functional and aesthetically pleasing.

ProSys Comfort™ black - R0145A6

- Power supply: 220V (50/60Hz)
- Power source: 350 Watt
- Insulation: IP66
- Push power: 6000N (ca 600kgf)
- Traction power: 3000N (ca 300kgf)
- Limit switch
- Easy and quick installation with EasyFix™ brackets
- Tempered glass front cover in black (6x400x1345mm)

*see page 30 for compatible flush plates

Wall-hung WC: AquaBlade® Connect Air
Frame: ProSys Comfort™ in black glass
Wall-hung bidet: Connect Air
Bidet mixer: Connect Air



ProSys™ accessories

We offer accessory kits to enable different kinds of installation in various environments. We also offer sound insulation kits that considerably reduce the amount of noise that passes through walls and floors into neighbouring rooms.

1 Noise insulation kits

Frame to floor – R010667

- Acoustic insulation
- Avoids direct contact between the frame and the floor

WC – R017467

- Acoustic insulation in expanded polyethylene
- Avoids direct contact between the WC bowl and the tiles

2 Flow rate reducer

R019867

- Reduces flow rate to avoid splashing
- Compatible with ProSys™ 80 and ProSys™ 150 cisterns

3 Corner installation kit

R018567

- Enables the installation of WCs in bathroom corners
- Compatible with 1150mm or 1130mm high dry wall frames.

4 Connection pipes

- S-bend outlet – R020367
- Horizontal outlet WC – R019967
- Telescopic connection pipe – R0200AC
- Flexible outlet WC bend – R019567

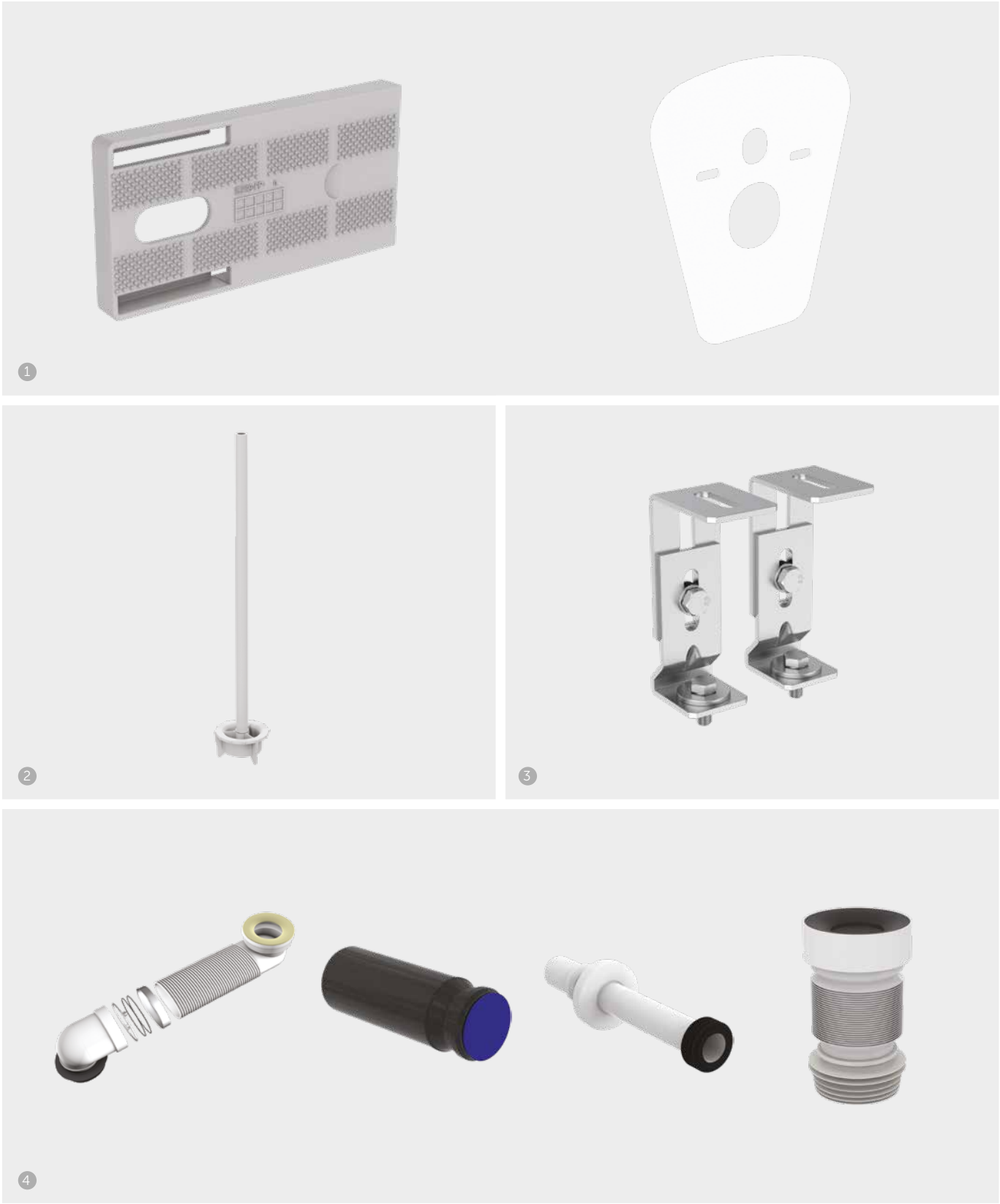

1. Noise insulation kits: Frame to floor; WC
2. Flow rate reducer
3. Corner installation kit
4. S-bend outlet; horizontal outlet WC; telescopic connection pipe; flexible outlet WC bend

Images are not to scale and some accessory pieces may be smaller than they appear in relation to other items

ProSys™ non-WC solutions

Bidet frames

Bidets offer improved hygiene and comfort in private as well as hotel bathrooms.

The ProSys™ frames for wall-hung bidets provide safe and versatile installation solutions for solid and dry-wall applications. All bidet frames are corrosion-resistant and tested to hold up to 400kg.

It's important for bidets to be correctly aligned next to WCs. This is more easily done using our ProSys™ frames.

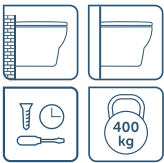

- Bidet frame – R016267**
- For built-in or plasterboard wall installation
 - Easy and quick installation with EasyFix™ system
 - Height adjustable from 0 to 300mm
 - Adjustable mounting brackets



- Bidet light frame – R016567**
- For built-in wall installation
 - 80mm thick
 - Adjustable attachment plate



- Bidet half frame – R015967**
- For built-in or plasterboard wall installation
 - Adjustable height
 - Adjustable fixing brackets



Bidet: Strada II
Bidet mixer: Edge
Frame: ProSys™ bidet frame



Basin: Strada II 100cm
Fitting: Edge
Frame: ProSys™ basin frame deck taps

ProSys™ non-WC solutions Basin frames

The ProSys™ range includes four different installation solutions for wall-hung washbasins. We also offer a solution for wall-mounted fittings. There is also a variant that features a concealed syphon trap, which is ideal for accessible washbasins, and our basin light frame specifically designed for solid wall applications. The frames are not only easy to install, but are also thoroughly tested for loads up to 150kg.



Basin frame deck taps – R010267

- For built-in or plasterboard wall installation
- Painted tubular frame with 1.5mm thickness, corrosion-resistant
- Height adjustable from 0 to 300mm
- Adjustable attachment plates

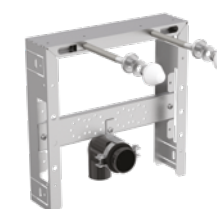

Basin light frame – R016467

- For built-in wall installation 80mm thick
- Adjustable attachment plates



Basin frame wall taps – R016167

- For built-in or plasterboard wall installation
- Painted tubular frame with 1.5mm thickness, corrosion-resistant
- Height adjustable from 0 to 300mm
- Adjustable attachment plates

ProSys™ non-WC solutions

Shower frames

The ProSys™ range offers two different shower frames that perfectly match the Ideal Standard ranges of fittings and rain showers. On project work, these can save time and ensure consistent quality of installation.



Shower frame fitting – R016667

- Frame for built-in shower valve/mixer, and for dry-wall installation
- Depth adjustable
- Adjustable attachment plates



Shower frame fitting and shower head – R016767

- Frame for built in shower valve and fixed shower hose and arm
- Solid wall or dry-wall installation
- Height adjustable
- Adjustable attachment plates

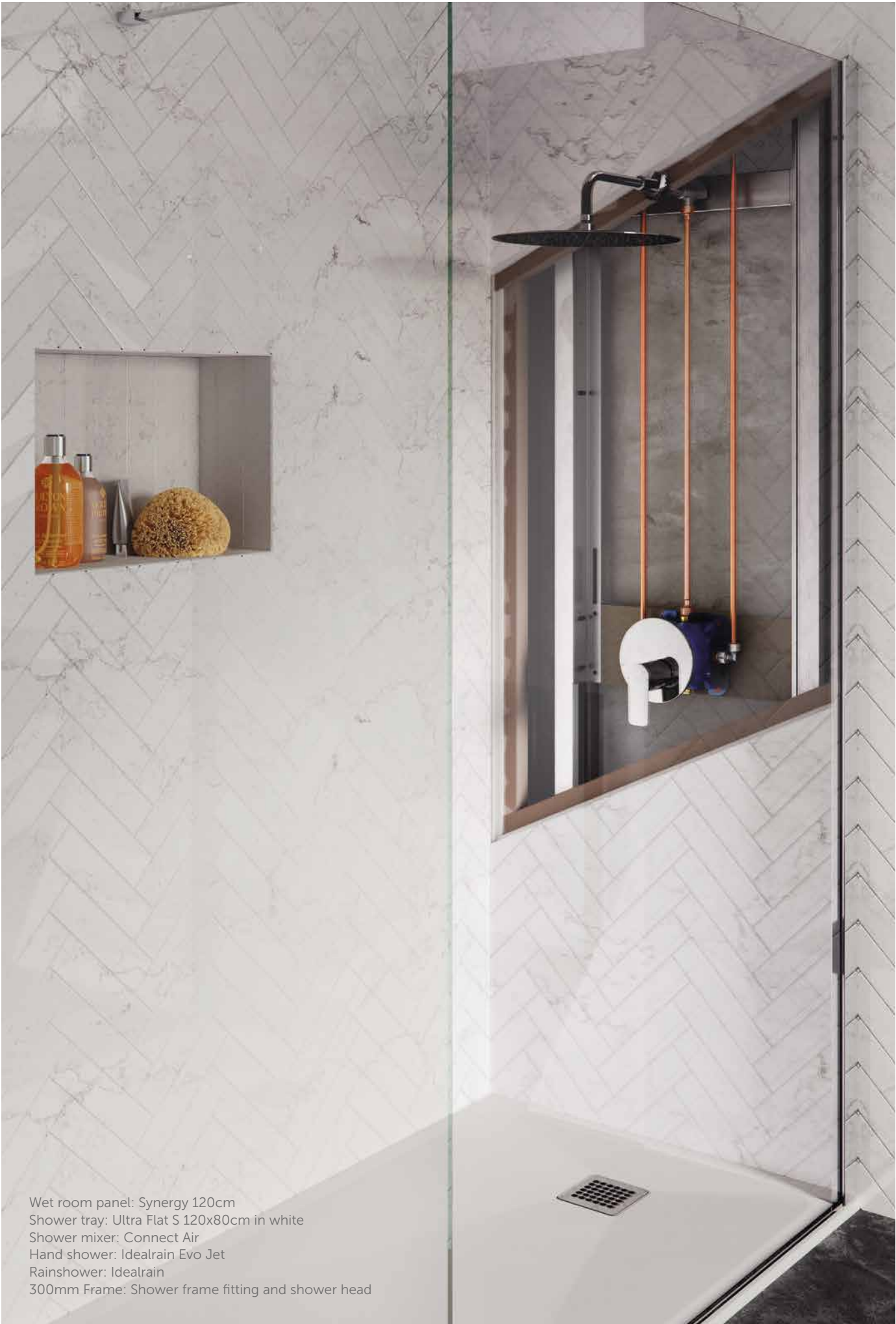

Wet room panel: Synergy 120cm
 Shower tray: Ultra Flat S 120x80cm in white
 Shower mixer: Connect Air
 Hand shower: Idealrain Evo Jet
 Rainshower: Idealrain
 300mm Frame: Shower frame fitting and shower head



Urinal: Sphero™ Maxi
Frame: ProSys™ urinal frame basic

ProSys™ non-WC solutions

Urinal frames

Urinals are essential fixtures in public and commercial bathrooms. When installed with the ProSys™ urinal frames they offer a hygienic and cost-efficient solution that will last. Our urinal frames are corrosion-resistant and load tested for 100kg. They can be adjusted for height and width, making them compatible with all urinals and the easy way to ensure speed and consistency of fitting on project work.



Urinal frame – R010367

- For built-in or plasterboard wall installation
- Quick installation with easy fixation EasyFix™ wall brackets
- Height adjustable from 0 to 300mm
- Adjustable wall brackets
- For exposed flushing valve installation



Urinal frame universal – R016367

- For built-in or plasterboard wall installation
- Quick installation with easy fixation EasyFix™ wall brackets
- Height adjustable from 0 to 300mm
- Adjustable wall brackets
- Built in electronic or pneumatic installation
- Compatible with ProSys™ urinal flush plates

Accessory frame

The same height as our standard WC frames, the ProSys™ accessory frame is the ideal solution to safely install urinal dividers or wall-hung support rails. Our EasyFix™ brackets provides an effortless and quick installation.



Accessory frame - R010567

- For built-in or plasterboard wall installation
- Painted tubular frame, corrosion-resistant
- Height adjustable from 0 to 200mm
- Strengthened wood panel
- Quick installation with easy fixation EasyFix™ wall brackets

Flush Plates

Perfect finishing

Whatever your bathroom vision, it's the details that make the difference. That's why our range of flush plates offers a choice of shapes, colours, functions and materials to meet any design need.

You can choose from mechanical, pneumatic, and electronic "no touch" actuation (with either capacitive or infrared sensors) for a new level of hygiene and convenience at the wave of a hand. For public washroom environments, we also offer vandal-resistant models.

Altes™



Altes™ NT1 White
Altes™ NT1 Black

Symfo™



Symfo™ NT1 White
Symfo™ NT1 Black

Oleas™



Oleas™ M1/P1 White
Oleas™ M1/P1 Black
Oleas™ M1/P1 Chrome
Oleas™ M1/P1 Matt chrome



Oleas™ M2/P2 White
Oleas™ M2/P2 Black
Oleas™ M2/P2 Chrome
Oleas™ M2/P2 Matt chrome



Oleas™ M3/P3 White
Oleas™ M3/P3 Black
Oleas™ M3/P3 Chrome
Oleas™ M3/P3 Matt chrome

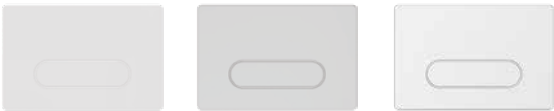

Oleas™ M4 White
Oleas™ M4 Chrome
Oleas™ M4 Matt chrome

Solea™



Solea™ M1 White
Solea™ M1 Chrome



Solea™ M2 White
Solea™ M2 Chrome



Solea™ P1 White
Solea™ P1 Chrome
Solea™ P1 Matt chrome



Solea™ P2 White
Solea™ P2 Black soft-touch
Solea™ P2 Chrome
Solea™ P2 Matt chrome

Septa Pro™

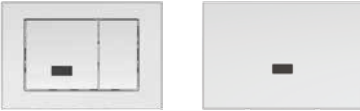

Septa Pro™ E1 Chrome
Septa Pro™ E2 Chrome



Septa Pro™ M1 Chrome
Septa Pro™ M2 Chrome



Septa Pro™ P1 Polished steel and chrome
Septa Pro™ P2 Polished steel and chrome
Septa Pro™ P3 Polished steel and chrome



Septa Pro™ P4 White
Septa Pro™ P4 Chrome



Septa™ Floor Stainless steel



Septa Pro™ XS P1 Chrome
Septa™ XS P2 White

Septa Pro™ Urinals



Septa Pro™ U1 Chrome
Septa Pro™ U2 Chrome
Septa Pro™ U3 White
Septa Pro™ U3 Chrome
Septa Pro™ U3 Matt chrome

Flush Plates

Altes™ and Symfo™

Ideal Standard’s new Altes™ and Symfo™ ranges feature the latest no-touch technology, so the user just moves their hand near three lines designed into the glass for a full flush or over the single line graphic for a half flush – making the flush plates easy to use and ultra-hygienic.

The Altes™ range is made from a beautiful ceramic, giving the plates a unique and elegant ‘silky’ finish. Available in either black or white, it blends seamlessly into any environment and works particularly well with the soft geometric design and gentle minimalism of our Strada II ceramic range.

Symfo™ is a tempered glass plate, with a minimalist, borderless design. Its reflective appearance gives a contemporary look and feel and is the perfect complement to the lighter design and thin, curved rims of our Connect Air ceramic range.

The LED backlights on the Altes™ and Symfo™ flush plates are factory set to blue, but can be adjusted at installation to any of the following colours: red, yellow, white, green, violet, orange or purple.



Overview

- Water-saving dual flush
- No-touch actuation – through capacitive sensors
- One piece ceramic (Altes™) or tempered glass material (Symfo™)
- Hygienic and easy-to-clean
- Available in black or white

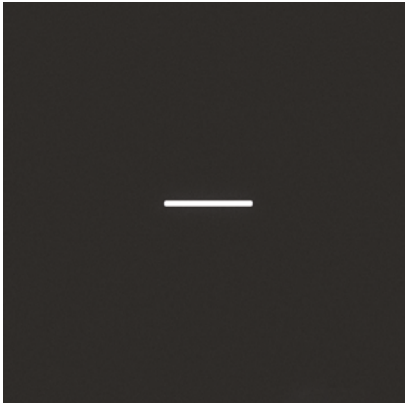

'Their aim is to create... objects that provide lasting pleasure'

Wall-hung AquaBlade®: Strada II
Wall-hung AquaBlade®: Connect Air



Flush plate detail: Altes™ NT1 in white ceramic
Flush plate detail: Symfo™ NT1 in black glass

Flush Plates

Oleas™

'The new flush plates
are an example of
design that fits in'

ROBIN LEVIEN



Available from September 2019, the new Oleas™ collection has been developed as part of Ideal Standard's long-standing and successful partnership with Studio Levien.

This collection features four minimalistic, highly functional models. Oleas™ flush plates are available with mechanical and pneumatic actuation, and selected mechanical versions are compatible with the SmartFlush system. Great care has gone into the movement – particularly the resistance and 'spring-back' of the buttons. The new Oleas™ flush plates look good, feel good, work well, and 'fit in'.

They work very well with the clean geometric lines and soft, rounded forms of our Tesi ceramics range.

Overview

- Four different designs
- Water-saving dual flush and single flush available
- Mechanical or pneumatic actuation
- Compatible with SmartFlush system (only with selected colours and mechanical actuation models)
- Available in different colours

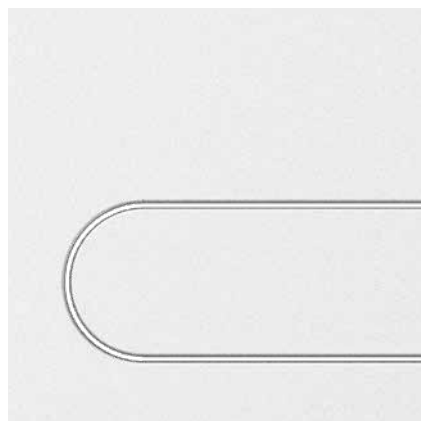

Studio**Levien**

L: Wall-hung bowl AquaBlade®: Tesi
R: Flush plate detail: Oleas™ M4 in matt chrome



Flush plate: Solea P2 in matt chrome
Wall-hung bowl AquaBlade®: Connect Air

Flush Plates

Solea™

Solea flush plates are classic shapes that complement other bathroom fixtures and easily blend into any bathroom design.

The range features products for mechanical and pneumatic flush actuation and comes in a variety of colours and finishes including black soft-touch. Solea™ M1 is a simple all-rounder that brings a timeless finish to your bathroom. Our M2 model combines straight and curved lines that complement a wide range of ceramics while the P1 model features organic round shapes in a soft minimalist design. The strikingly linear shape of Solea™ P2 adds a clean and defined look to your bathroom.

All Solea™ models feature dual flush so users choose how much water to use when flushing the toilet.

Overview

- Four different designs
- Water-saving dual flush
- Mechanical or pneumatic actuation
- Available in different colours

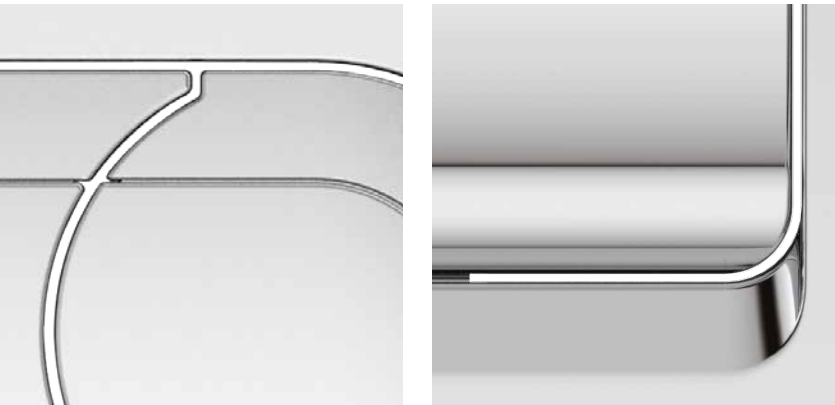

R: Flush plate detail: Solea™ M1 - in chrome
L: Flush plate detail: Solea™ P1 - in matt chrome

**‘Solea™ flush plates
blend into any
bathroom design’**

Flush Plates

Septa Pro™



Urinals: Sphero™ Midi
Urinal flush plate: Septa Pro™ U1
in chrome



Our range of Septa Pro™ flush plates are known for their versatility and durability. They come in a variety of shapes, sizes and finishes which makes them the perfect choice for any bathroom environment. Vandal-resistant and made with robust materials, they are particularly suitable for commercial, public and semi-public washrooms. High-tech features such as infrared actuation sensors also help make them more hygienic as there is no need to touch the flush plate. Additionally, the range includes models that can be installed away from the cistern for remote activation and easier access. Matching urinal flush plates can help complete your design vision.

Overview

- A range of different designs
- Water-saving dual flush and single flush available
- Mechanical, pneumatic and infrared sensor actuation available
- Vandal-resistant
- Available in different colours and materials



Flush plate: Septa Pro™ P1 in chrome
Wall-hung bowl: Aquablade® : Connect Air

**‘Septa Pro™ ...
the perfect choice
for any environment’**

Flush Plates

Compatibility with Cisterns and Conversion Kits

M: mechanical actuation
P: pneumatic actuation
M F: mechanical front actuation
M T: mechanical top actuation
N/C: not compatible
N/A: not applicable
1: denotes SmartForce



	MODEL	INSTALLATION ProSys™ 120 M	INSTALLATION ProSys™ 120 P	INSTALLATION ProSys™ 80 M	INSTALLATION ProSys™ 150 M front actuation	INSTALLATION ProSys™ 150 M top actuation
Mechanical	Oleas™ M1	•	N/C	•	•	+ R017667
	Oleas™ M2	•	N/C	•	•	+ R017667
	Oleas™ M3	•	N/C	•	•	+ R017667
	Oleas™ M4	•	N/C	•	•	+ R017667
	Solea™ M1	•	N/C	•	•	•
	Solea™ M2	•	N/C	•	•	•
	Septa Pro™ M1	•	N/C	•	•	•
	Septa Pro™ M2	•	N/C	•	•	•
Pneumatic	Oleas™ P1	+ R009867	•	+ R014967	+ R009267	+ R009267
	Oleas™ P2	+ R009867	•	+ R014967	+ R009267	+ R009267
	Oleas™ P3	+ R009867	•	+ R014967	+ R009267	+ R009267
	Solea™ P1	+ R009867	•	+ R014967	+ R009267	+ R009267
	Solea™ P2	+ R009867	•	+ R014967	+ R009267	+ R009267
	Septa Pro™ P1	+ R009867	•	+ R014967	+ R009267	+ R009267
	Septa Pro™ P2	+ R009867	•	+ R014967	+ R009267	+ R009267
	Septa Pro™ P3	+ R009867	•	+ R014967	+ R009267	+ R009267
	Septa Pro™ P4	+ R009867	•	+ R014967	+ R009267	+ R009267
	Septa Pro™ Floor	+ R009867	•	+ R014967	+ R009267	+ R009267
	Septa™ XS P1	+ R009867	•	+ R014967	+ R009267	+ R009267
	Septa™ XS P2	+ R009867	•	+ R014967	+ R009267	+ R009267
Electronic	Septa Pro™ E1	R015767	+ R009967	R019167	N/C	N/C
	Septa Pro™ E2	R015767	+ R009967	R019167	N/C	N/C
	Symfo™ NT1	+ R015867 / R015767 ¹	+ R015867	+ R015067 / R019167 ¹	N/C	N/C
	Altes™ NT1	+ R015867 / R015767 ¹	+ R015867	+ R015067 / R019167 ¹	N/C	N/C

Flush Plates

Minimum wall thickness (mm)

M: mechanical actuation
P: pneumatic actuation
M F: mechanical front actuation
M T: mechanical top actuation
N/C: not compatible
N/A: not applicable



	MODEL	INSTALLATION ProSys™ 120 M	INSTALLATION ProSys™ 120 P	INSTALLATION ProSys™ 80 M	INSTALLATION ProSys™ 150 M front actuation	INSTALLATION ProSys™ 150 M top actuation
Mechanical	Oleas™ M1	15	15	0	0	0
	Oleas™ M2	15	15	0	0	0
	Oleas™ M3	15	15	0	0	0
	Oleas™ M4	15	15	0	0	0
	Solea™ M1	10	10	0	0	0
	Solea™ M2	10	10	0	0	0
	Septa Pro™ M1	10	10	0	0	0
	Septa Pro™ M2	10	10	0	0	0
Pneumatic	Oleas™ P1	40	40	25	0	25
	Oleas™ P2	40	40	25	0	25
	Oleas™ P3	40	40	25	0	25
	Solea™ P1	20	20	25	0	20
	Solea™ P2	25	25	25	0	20
	Septa Pro™ P1	10	10	0	0	0
	Septa Pro™ P2*	N/A	N/A	N/A	N/A	N/A
	Septa Pro™ P3*	N/A	N/A	N/A	N/A	N/A
	Septa Pro™ P4*	N/A	N/A	N/A	N/A	N/A
	Septa™ Floor	N/A	N/A	N/A	N/A	N/A
	Septa™ XS P1*	N/A	N/A	N/A	N/A	N/A
	Septa™ XS P2*					
Electronic	Septa Pro™ E1	10	10	10	N/C	N/C
	Septa Pro™ E2	10	10	10	N/C	N/C
	Symfo™ NT1	10	10	0	N/C	N/C
	Altes™ NT1	10	10	0	N/C	N/C

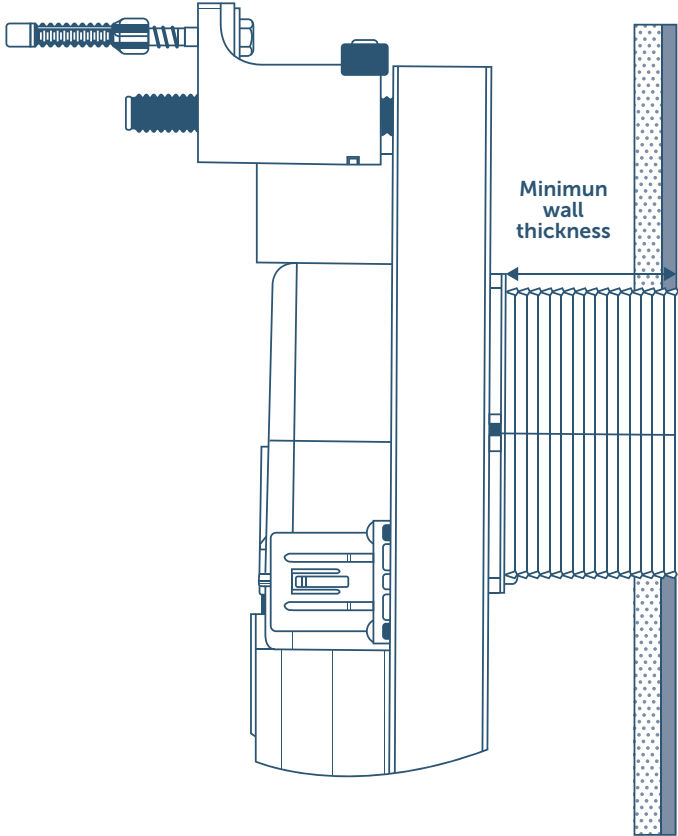

*No minimum wall thickness required as flush plate is not installed in front of the cistern. An inspection plate is required to access the cistern.

Solutions for any project

Stadiums and transport hubs

We offer a range of durable, easy-to-clean and cost-efficient products and technologies for use in high-traffic washrooms in transport hubs and sports stadiums.

Hotels and restaurants

Reliable, well-designed products that are suited to everything from busy public washrooms to exclusive guest bathrooms.

Apartment blocks

Sound insulation and optimum space utilisation can all be enhanced by our pre-wall systems, flush plates, ceramics and fittings.

Workplaces

High-quality design for visitor areas and hard-wearing, easy-to-maintain systems for heavily used employee washrooms, along with high-technology flush systems and taps to reduce operating costs.

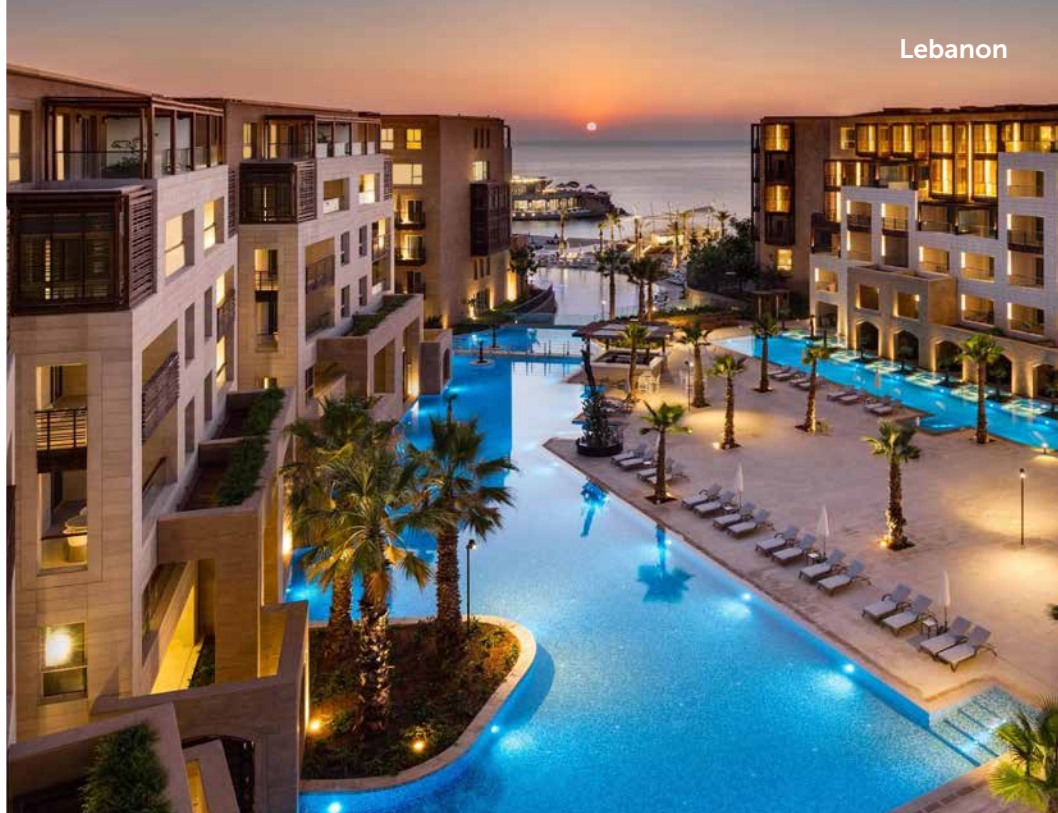

Hospitals

Hygiene is the primary concern in hospitals and care facilities. Ideal Standard offer a number of specialised products that improve hygiene.

Private homes

All the design choices you need to create the perfect bathroom or modernise an existing one.

Education

We offer a full range of child-friendly products in age-appropriate sizes and designs.

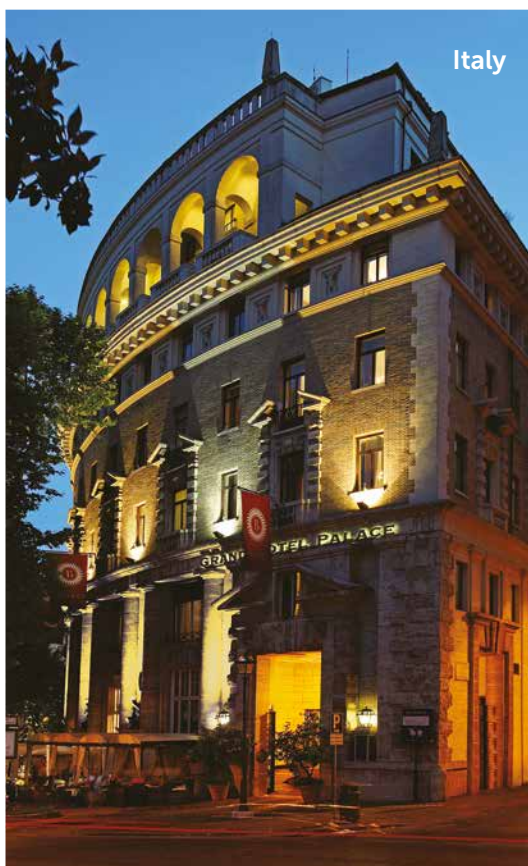
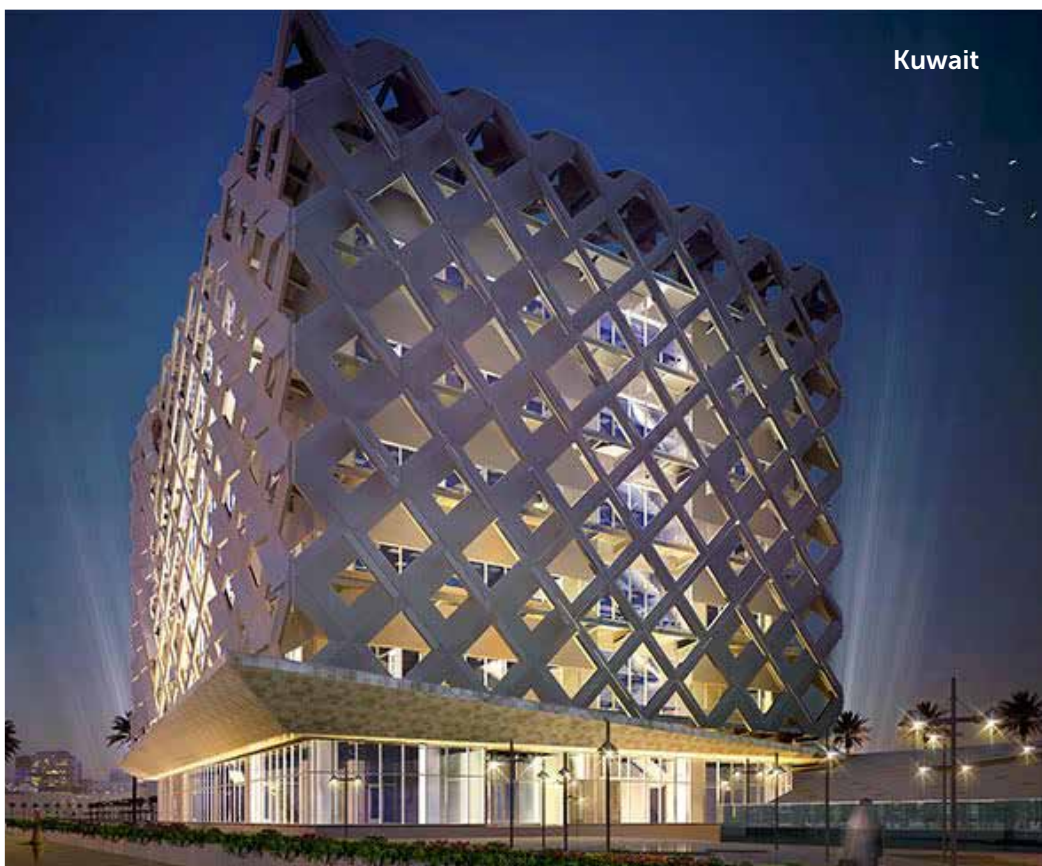

Technical information

ProSys™ 120



WC Cistern 120 M



Model	Ref
WC Cistern 120 M	R015667

- Compatible with back to wall free-standing WC bowls
- For installation into masonry constructed walls
- Minimum wall depth 126mm
- Supplied with anti-condensation lining and plaster mesh
- Mechanical flush plate actuation
- Pneumatic and electronic flush plate conversion kits available
- Fully maintainable through service tunnel positioned at the front of the tank

Characteristics

- Dual flush pre-set at 6L/3L
- Simple adjustment to reduce full flush from 6 to 4/4.5L
- Polypropylene tank which has good chemical, fatigue and heat resistant properties
- NF-certified Class 1 silent fill inlet valve with patented water saving delayed fill feature
- 3mm thick tank; delivered with anti-condensation lining;
- CE marking EN 14055 Class 1 Type 6 & 4
- 2 water supply options (back centre top & left side top)
- Supplied with reversible cistern brackets for either back or front face fixings
- WC flush pipe and seal



WC Light Frame 120 M



Model	Ref
WC Light Frame 120 M	R009767

- Compatible with all wall-hung WC bowls
- For built-in installation into masonry constructed walls
- Frame load tested to 400 kilos
- Expanded polystyrene that encases the cistern for faster installation and excellent insulation
- Actual cistern depth 144mm
- Mechanical flush plate actuation
- Pneumatic and electronic flush plate conversion kits available
- Fully maintainable through service tunnel positioned at the front of the tank

Characteristics

- Double flush pre-set at 6L/3L
- Simple adjustment to reduce full flush from 6 to 4.5L
- Polypropylene tank which has good chemical, fatigue and heat resistant properties
- NF-certified Class 1 silent fill inlet valve with patented water saving delayed fill feature
- 3mm thick tank; delivered with anti-condensation lining
- CE marking EN 14055 Class 1 Type 6 and 4
- Water supply rear centre top with inboard isolation for easier servicing & maintenance
- Supplied with all frame and WC bowl fixings
- 90mm diameter connection pipe and 90/90 outlet bend with 90/100 and 90/110 adapters



WC Frame 120 M



Model	Ref
WC Frame 120 M	R009467

- Compatible with wall-hung WC bowls
- For built-in installation into masonry and plasterboard constructed walls
- Frame load tested to 400 kilos
- Quick adjustable height legs with brakes allowing one person installation
- Height adjustable from 0 to 200 mm
- Easy and quick installation with EasyFix® wall brackets
- Depth adjustable from 150 to 210 mm
- Frame corrosion and scratch resistant
- Depth and directional adjustable outlet bend
- Mechanical flush plate actuation
- Pneumatic and electronic flush plate conversion kits available
- Fully maintainable through service tunnel positioned at the front of the tank

Characteristics

- Dual flush pre-set at 6L/3L
- Simple adjustment to reduce full flush from 6 to 4.5L
- Polypropylene tank which has good chemical, fatigue and heat resistant properties
- NF-certified Class 1 silent fill inlet valve with patented water saving delayed fill feature
- 3mm thick tank; delivered with anti-condensation lining
- CE marking EN 14055 Class 1 Type 6 & 4
- 2 water supply options (back centre top & left side top)
- Supplied with all frame and WC bowl fixings
- 90mm diameter connection pipe and 90/90 outlet bend with 90/100 and 90/110 adapters

Technical information

ProSys™ 120



WC Frame 120 M 3 Heights



Model	Ref
WC Frame 120 M 3H	R009567

- Compatible with all wall-hung WC bowls
- For built-in installation into masonry and plasterboard constructed walls
- Allows height adjustment of the WC pan fixation in three different positions prior to wall closure
- Frame load tested to 400 kilos
- Quick adjustable height legs with brakes allowing one person installation
- Height adjustable from 0 to 200 mm
- Easy and quick installation with EasyFix® wall brackets
- Depth adjustable from 150 to 210mm
- Frame corrosion and scratch resistant
- Depth and directional adjustable outlet bend
- Mechanical flush plate actuation
- Pneumatic and electronic flush plate conversion kits available
- Fully maintainable through service tunnel positioned at the front of the tank

Characteristics

- Dual flush pre-set at 6L/3L
- Simple adjustment to reduce full flush from 6 to 4.5L
- Polypropylene tank which has good chemical, fatigue and heat resistant properties
- NF-certified Class 1 silent fill inlet valve with patented water saving delayed fill feature
- 3mm thick tank; delivered with anti-condensation lining
- CE marking EN 14055 Class 1
- 2 water supply options (back centre top & left side top)
- Supplied with all frame and WC bowl fixings
- 90mm diameter connection pipe and 90/90 outlet bend with 90/100 and 90/110 adapters



WC Frame Freestanding 120 M



Model	Ref
WC Frame FS 120 M	R015467

- Compatible with all wall-hung WC bowls
- For built-in installation into plasterboard constructed walls
- Frame load tested to 400 kilos
- Quick adjustable height legs with brakes allowing one person installation
- Height adjustable from 0 to 200 mm
- Frame corrosion and scratch resistant
- Easy and quick installation with EasyFix® wall brackets
- Depth and directional adjustable outlet bend
- Mechanical flush plate actuation
- Electronic flush plate conversion kits available
- Fully maintainable through service tunnel positioned at the front of the tank

Characteristics

- Dual flush pre-set at 6L/3L
- Simple adjustment to reduce full flush from 6 to 4.5L
- Polypropylene tank which has good chemical, fatigue and heat resistant properties
- NF-certified Class 1 silent fill inlet valve with patented water saving delayed fill feature
- 3mm thick tank; delivered with anti-condensation lining
- CE marking EN 14055 Class 1
- 2 water supply options (back centre top & left side top)
- Supplied with all frame and WC bowl fixings
- 90mm diameter connection pipe and 90/100mm outlet bend



WC Frame Freestanding 120 P



Model	Ref
WC Frame FS 120 P	R009667

- Compatible with all wall-hung WC bowls
- For built-in installation into plasterboard constructed walls
- Frame load tested to 400 kilos
- Quick adjustable height legs with brakes allowing one person installation
- Height adjustable from 0 to 200 mm
- Easy and quick installation with EasyFix® wall brackets
- Frame corrosion and scratch resistant
- Depth and directional adjustable outlet bend
- Pneumatic flush plate actuation
- Electronic flush plate conversion kits available
- Fully maintainable through service tunnel positioned at the front of the tank

Characteristics

- Dual flush pre-set at 6L/3L
- Simple adjustment to reduce full flush from 6 to 4.5L
- Polypropylene tank which has good chemical, fatigue and heat resistant properties
- NF-certified Class 1 silent fill inlet valve with patented water saving delayed fill feature
- 3mm thick tank; delivered with anti-condensation lining
- CE marking EN 14055 Class 1
- 2 water supply options (back centre top & left side top)
- Supplied with all frame and WC bowl fixings
- 90mm diameter connection pipe and 90/100mm outlet bend

Technical information

ProSys™ 80



WC Cistern 80 M



Model	Ref
WC Cistern 80 M	R014767

- Compatible with back to wall free-standing WC bowls
- For installation into masonry constructed walls
- Minimum wall depth 80mm
- Supplied with anti-condensation lining and plaster mesh
- Mechanical flush plate actuation
- Pneumatic and electronic flush plate conversion kits available
- Fully maintainable through service tunnel positioned at the front of the tank

Characteristics:

- Dual flush pre-set at 6L/3L Type 6
- Simple adjustment to reduce full flush from 6 to 4.5/5.5L Type 5
- Polypropylene tank which has good chemical, fatigue and heat resistant properties
- NF-certified Class 1 silent fill inlet valve with patented water saving delayed fill feature
- 3mm thick tank; delivered with anti-condensation lining;
- CE marking EN 14055 Class 1 Type 6 & 4
- 3 water supply options (centre top, left and right of centre)
- Supplied with integral cistern fixing brackets and adjustable hanger brackets
- WC flush pipe and seal fully encased in blue EPS insulation



WC Light Frame 80 M



Model	Ref
WC Light Frame 80 M	R014667

- Compatible with all wall-hung WC bowls
- For built-in installation into masonry and plasterboard constructed walls
- Frame load tested to 400 kilos
- Minimum depth 80mm
- Mechanical flush plate actuation
- Pneumatic and electronic flush plate conversion kits available
- Fully maintainable through service tunnel positioned at the front of the tank

Characteristics

- Double flush pre-set at 6L/3L
- Simple adjustment to reduce full flush from 6 to 4.5L
- Polypropylene tank which has good chemical, fatigue and heat resistant properties
- NF-certified Class 1 silent fill inlet valve with patented water saving delayed fill feature
- 3mm thick tank; supplied with anti-condensation lining
- CE marking EN 14055 Class 1 Type 6 and 5
- 3 water supply options (centre top, left and right of centre)
- Supplied with all frame and WC bowl fixings
- 90mm diameter connection pipe and 90/100mm adapter



WC Frame 80 M



Model	Ref
WC Frame 80 M	R014367

- Compatible with all wall-hung WC bowls
- For built-in installation into masonry and plasterboard constructed walls
- Height adjustable legs 0 > 200mm
- Frame load tested to 400 kilos
- Adjustable depth 120 >170mm
- Mechanical flush plate actuation
- Pneumatic and electronic flush plate conversion kits available
- Fully maintainable through service tunnel positioned at the front of the tank

Characteristics

- Double flush pre-set at 6L/3L
- Simple adjustment to reduce full flush from 6 to 4.5L
- Polypropylene tank which has good chemical, fatigue and heat resistant properties
- NF-certified Class 1 silent fill inlet valve with patented water saving delayed fill feature
- 3mm thick tank; supplied with anti-condensation lining
- CE marking EN 14055 Class 1 Type 6 and 5
- 3 water supply options (centre top, left and right of centre)
- Supplied with all frame and WC bowl fixings
- 90mm diameter connection pipe and 90/100mm adapter

Technical information

ProSys™ 150



WC Cistern 150 M



Model	Ref
WC Cistern 150 M	R014167

- Compatible with back to wall free-standing WC bowls
- For installation into masonry constructed walls
- Minimum wall depth 150mm
- Supplied with anti-condensation lining
- Mechanical flush plate actuation compatible with Solea M1, Solea M2 and Septa Pro M1
- Requires separate central block R017667 for top actuation of Oleas M1, M2, M3 & M4 flush plates
- Pneumatic flush plate conversion kits available
- Fully maintainable through service tunnel positioned at the front or top of the tank

Characteristics

- Dual flush pre-set at 6L/3L Type 6
- Simple adjustment to reduce full flush from 6 to 4.5/5.5L Type 5
- Polypropylene tank which has good chemical, fatigue and heat resistant properties
- NF-certified Class 1 silent fill inlet valve with patented water saving delayed fill feature
- 3mm thick tank; delivered with anti-condensation lining;
- CE marking EN 14055 Class 1 Type 6 & 4
- 3 options for water supply top right hand and side inlet left and right
- Supplied with cistern wall brackets
- WC flush pipe and seal



WC Frame 150 M



Model	Ref
WC Frame 150 M	R009067

- Compatible with all wall-hung WC bowls
- For built-in installation into masonry and plasterboard constructed walls
- Frame load tested to 400 kilos
- Quick adjustable height legs with brakes allowing one person installation
- Height adjustable from 0 to 200 mm
- 820mm overall height suitable for lower/under window installation
- Adjustable depth 150 > 200mm
- Depth and directional adjustable outlet bend
- Mechanical flush plate actuation
- Pneumatic flush plate conversion kits available
- Fully maintainable through service tunnel positioned at the front or top of the tank

Characteristics

- Dual flush pre-set at 6L/3L
- Simple adjustment to reduce full flush from 6 to 4.5L
- Polypropylene tank which has good chemical, fatigue and heat resistant properties
- NF-certified Class 1 silent fill inlet valve with patented water saving delayed fill feature
- 3mm thick tank; supplied with anti-condensation lining
- CE marking EN 14055 Class 1 Type 6 and 5
- 3 options for water supply top right hand and side inlet left and right
- Supplied with all frame and WC bowl fixings
- 90mm diameter connection pipe, 90/90mm outlet bend, 90/100 and 90/110 adapters



WC Frame Freestanding 150 M



Model	Ref
WC Frame FS 150 M	R009167

- Compatible with all wall-hung WC bowls
- For built-in installation into masonry and plasterboard constructed walls
- Frame load tested to 400 kilos
- Quick adjustable height legs with brakes allowing one person installation
- Height adjustable from 0 to 200 mm
- 820mm overall height suitable for lower/under window installation
- Minimum depth 180mm
- Depth and directional adjustable outlet bend
- Mechanical flush plate actuation
- Pneumatic flush plate conversion kits available
- Fully maintainable through service tunnel positioned at the front or top of the tank

Characteristics

- Dual flush pre-set at 6L/3L
- Simple adjustment to reduce full flush from 6 to 4.5L
- Polypropylene tank which has good chemical, fatigue and heat resistant properties
- NF-certified Class 1 silent fill inlet valve with patented water saving delayed fill feature
- 3mm thick tank; supplied with anti-condensation lining
- CE marking EN 14055 Class 1 Type 6 and 5
- 3 options for water supply top right hand and side inlet left and right
- Supplied with all frame and WC bowl fixings
- 90mm diameter connection pipe, 90/90mm outlet bend, 90/100 and 90/110 adapters

Technical information

ProSys™ Comfort & NeoX™



ProSys™ Comfort WC Frame



Model	Ref
Black Glass	R0145A6

- Compatible with all wall-hung WC bowls
- 150mm WC bowl height adjustment for reduced mobility users
- Powered by in-frame silent motor, controlled by remote control
- For built-in installation into masonry and plasterboard constructed walls
- Frame load tested to 400 kilos
- Quick adjustable height legs and wall brackets facilitating one person installation
- Height adjustable from 0 to 200mm
- Adjustable depth 205 > 240mm
- Supplied with 6mm black glass plate
- Mechanical flush plate actuation
- Pneumatic and electronic flush plate conversion kits available
- Fully maintainable through service tunnel positioned at the front of the tank

Characteristics

- IP66 rated as defined in EN 60529
- Dual flush pre-set at 6L/3L
- Simple adjustment to reduce full flush from 6 to 4.5L
- Polypropylene tank which has good chemical, fatigue and heat resistant properties
- NF-certified Class 1 silent fill inlet valve with patented water saving delayed fill feature
- 5mm thick tank; supplied with anti-condensation lining
- CE marking EN 14055 Class 1 Type 6 and 5
- Water supply top left of centre with inboard isolation for easier servicing & maintenance
- Supplied with all frame and WC bowl fixings
- 90mm diameter connection pipe, 90/90mm flexible outlet bend, 90/100 and 90/110 adapters



NeoX™ WC Module

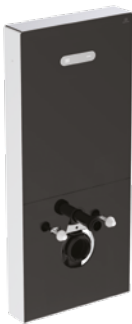

Model	Ref
White Glass	R0144AC
Black Glass	R0144A6

- Compatible with all wall-hung WC bowls
- One piece stainless steel frame with 2 part 6mm glass front panel
- For simple renovation without disturbing existing wall
- Frame load tested to 400 kilos
- Depth 108mm
- Glass available in black or white
- Pneumatic flush plate actuation with stainless steel
- Fully maintainable from the front top glass panel

Characteristics

- Dual flush pre-set at 6L/3L
- Simple adjustment to reduce full flush from 6 to 4.5L
- Polypropylene tank which has good chemical, fatigue and heat resistant properties
- NF-certified Class 1 silent fill inlet valve with patented water saving delayed fill feature
- 5mm thick tank; supplied with anti-condensation lining
- CE marking EN 14055 Class 1 Type 6 and 5
- 4 options for water supply connection points; left or right side, top or bottom of module
- Supplied with all frame and WC bowl fixings
- 90mm diameter connection pipe, 90/90mm outlet bend, 90/100 and 90/110 adapters

Technical information

WC Half Frames



WC Half Frame



Model	Ref
WC Half frame	R010067

- Compatible with all wall-hung WC bowls
- For built-in installation into masonry and plasterboard constructed walls
- Ideal for use where cistern is already fitted for example where floor standing WC is being replaced with a wall hung WC
- Frame load tested to 400 kilos
- Height adjustable from 0 to 200 mm
- Adjustable depth 130 > 185mm
- Depth and directional adjustable outlet bend

Characteristics

- Supplied with all frame and WC bowl fixings
- 90mm diameter connection pipe, 90/90mm outlet bend, 90/100 and 90/110 adapters



WC Half Frame Freestanding



Model	Ref
WC Half frame Freestanding	R010167

- Compatible with all wall-hung WC bowls
- For built-in installation into plasterboard constructed walls
- Ideal for use where cistern is already fitted for example where floor standing WC is being replaced with a wall hung WC
- Frame load tested to 400 kilos
- Height adjustable from 0 to 200 mm
- Minimum depth 185mm
- Depth and directional adjustable outlet bend

Characteristics

- Supplied with all frame and WC bowl fixings
- 90mm diameter connection pipe, 90/90mm outlet bend, 90/100 and 90/110 adapters

Technical information

Bidet Frames



Bidet Frame



Model	Ref
Bidet frame	R016267

- Compatible with all wall-hung bidets
- For built-in installation into masonry and plasterboard constructed walls
- Quick adjustable height legs with brakes allowing one person installation
- Height adjustable from 0 to 200 mm
- Easy and quick installation with EasyFix® wall brackets
- Frame load tested to 400 kilos
- Adjustable depth 120 > 165mm

- Characteristics
- Supplied with all frame and bidet bowl fixings
 - Outlet bend multi fit 40-32/50-40mm
 - 2 angled wall connectors ½ F x ½ M



Bidet Half Frame



Model	Ref
Bidet half frame	R015967

- Compatible with all wall-hung bidets
- For built-in installation into masonry and plasterboard constructed walls
- Frame load tested to 400 kilos
- Height adjustable
- Adjustable height bidet attachment
- Adjustable depth 80 > 120mm

- Characteristics
- Supplied with all frame and bidet bowl fixings
 - Outlet bend multi fit 40-32/50-40mm



Bidet Light Frame

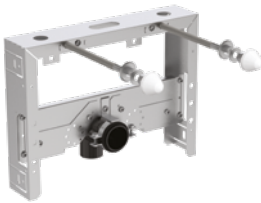

Model	Ref
Bidet light frame	R016567

- Compatible with all wall-hung bidets
- For built-in installation into masonry walls
- Frame load tested to 400 kilos
- Adjustable height bidet attachment plates
- Minimum depth 80mm

- Characteristics
- Supplied with all frame and bidet bowl fixings
 - Outlet bend multi fit 40-32/50-40mm

Technical information

Urinal Frames



Universal Urinal Frame



Model	Ref
Universal urinal frame	R016367

- Compatible with all wall-hung urinals
- For built-in installation into masonry and plasterboard constructed walls
- Height adjustable legs from 0 to 300 mm
- Easy and quick installation with EasyFix® wall brackets
- Adjustable depth 120 > 170
- Frame load tested to 100 kilos
- Adjustable height attachment bars
- Top recessed fixing panel for built in or infrared urinal flush control

- Characteristics
- Supplied with all frame fixings
 - Outlet bend 50/50mm
 - Outlet bend seal 50mm
 - 1 angled wall connector ½ F x ½ M



Urinal Frame



Model	Ref
Urinal frame	R010367

- Compatible with all wall-hung urinals
- For built-in installation into masonry and plasterboard constructed walls
- Height adjustable legs from 0 to 300 mm
- Easy and quick installation with EasyFix® wall brackets
- Adjustable depth 120 > 170
- Frame load tested to 100 kilos
- Adjustable height attachment bars
- For exposed manual urinal flush control

- Characteristics
- Supplied with all frame fixings
 - Outlet bend 50/50mm
 - Outlet bend seal 50mm
 - 1 angled wall connector ½ F x ½ M

Technical information

Basin Frames

Basin Frame Deck Taps



Model	Ref
Basin Frame Deck Taps	R010267

- Compatible with all wall-hung basins with deck mounted taps
- For built-in installation into masonry and plasterboard constructed walls
- Height adjustable legs from 0 to 300 mm
- Easy and quick installation with EasyFix® wall brackets
- Adjustable depth 120 > 170
- Frame load tested to 150 kilos
- Adjustable height attachment bars
- Water connections pre drilled at 80 and 280mm centres

- Characteristics
- Supplied with all frame and basin fixings
 - Outlet bend multi fit 40-32/50-40mm
 - 2 angled wall connector ½ F x ½ M

Basin Frame Wall Taps



Model	Ref
Basin Frame Wall Taps	R016167

- Compatible with all wall-hung basins with wall mounted taps
- For built-in installation into masonry and plasterboard constructed walls
- Height adjustable legs from 0 to 300 mm
- Easy and quick installation with EasyFix® wall brackets
- Adjustable depth 120 > 170
- Frame load tested to 150 kilos
- Adjustable height attachment bars

- Characteristics
- Supplied with all frame and basin fixings
 - Outlet bend multi fit 40-32/50-40mm
 - 2 angled wall connector ½ F x ½ M

Basin Light Frame



Model	Ref
Basin Light Frame	R016467

- Compatible with all wall-hung basins
- For built-in installation into masonry walls
- Frame load tested to 400 kilos
- Adjustable height bidet attachment plates
- Minimum depth 80mm

- Characteristics
- Supplied with all frame and basin fixings
 - Outlet bend multi fit 40-32/50-40mm

Technical information

Shower Frames



Shower Frame Valve & Head



Model	Ref
Shower Frame Valve & Head	R016767

- Compatible with built in shower valve
- For installation into masonry and plasterboard constructed walls
- Adjustable depth for shower valve
- Adjustable height for shower arm & hose

- Characteristics
- Supplied with all frame fixings
 - 1 x angled wall connector ½"F x ½"M

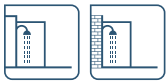

Shower Frame Valve



Model	Ref
Shower Frame Valve	R016667

- Compatible with built in shower valve
- For installation into masonry and plasterboard constructed walls
- Adjustable depth for shower valve

- Characteristics
- Supplied with all frame fixings
 - 2 x angled wall connector ½"F x ½"M

Technical information

Accessory Frame



Accessory Frame



Model	Ref
Accessory Frame	R010567

- Compatible with hinged arm support rails, fixed grab rail or urinal divider
- For installation into masonry and plasterboard constructed walls
- Height adjustable from 0 to 200 mm
- Easy and quick installation with EasyFix® wall brackets
- Depth adjustable from 120 to 170 mm

Characteristics:

- Supplied with all frame fixings



Wall-hung WC: AquaBlade® Strada II
Flush plate: Oleas™ P2
Vessel: Strada II
Vessel mixer: Edge
Furniture: Adapto

Technical information

Flush plates



Altes™ NT1

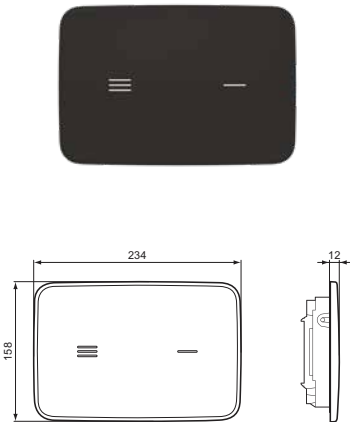

Model	Ref
NT1 White	R0130AC
NT1 Black	R0130A6

- One-piece ceramic material
- Dual flush
- No-touch activation through capacitive sensors
- Detection capacity – about 20mm
- Sensor sensitivity adjustment
- Duty flush and timing
- Waterproof connectors
- Anti-error electronic connections
- Operating temperature 0 – 70°C
- Degree of sensor protection: IP67
- Electronic connectors anti-error and waterproof: IP66
- Hygienic and easy to clean



Symfo™ NT1

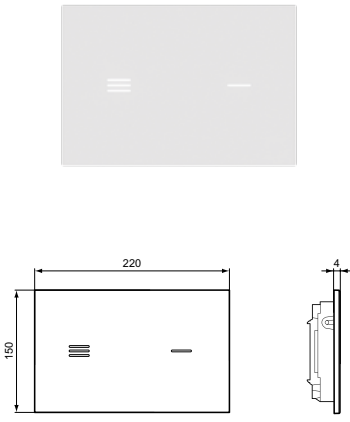

Model	Ref
NT1 White	R0129SA
NT1 Black	R0129RX

- One-piece tempered glass
- Dual flush
- No-touch activation through capacitive sensors with LED signs (sensor lighting adjustment; multiple LED back light colours: blue, red, yellow, white, green, violet, orange and purple)
- Detection capacity – about 20mm
- Sensor sensitivity adjustment
- Duty flush and timing
- Gull-Wing opening system which prevents damages to the control plate in actions of installation and maintenance
- Waterproof connectors
- Anti-error electronic connections
- Hygienic and easy to clean



Oleas™ M1

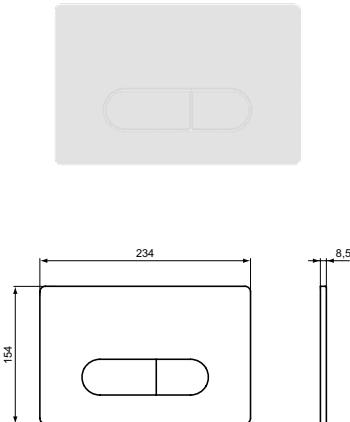

Model	Ref
M1 White	R0115AC
M1 White SF*	R0117AC
M1 Chrome	R0115AA
M1 Chrome SF*	R0117AA
M1 Matt Chrome	R0115JG
M1 Matt Chrome SF*	R0117JG
M1 Black	R0115A6

- Round design
- Dual flush
- Mechanical actuation
- Actuation force < 20N
- SmartFlush variants available

*SF SmartFlush



Oleas™ M2

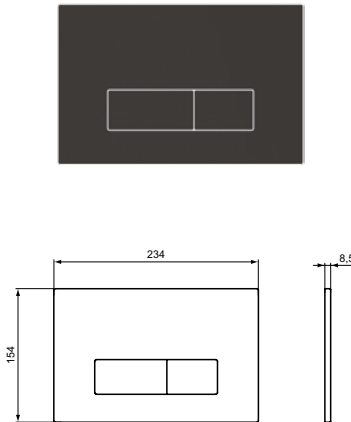

Model	Ref
M2 White	R0121AC
M2 White SF*	R0122AC
M2 Chrome	R0121AA
M2 Chrome SF*	R0122AA
M2 Matt Chrome	R0121JG
M2 Matt Chrome SF*	R0122JG
M2 Black	R0121A6

- Square design
- Dual flush
- Mechanical actuation
- Actuation force < 20N
- SmartFlush variants available

*SF SmartFlush



Oleas™ M3

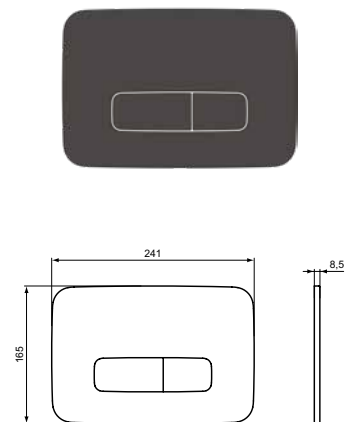

Model	Ref
M3 White	R0123AC
M3 Chrome	R0123AA
M3 Matt Chrome	R0123JG
M3 Black	R0123A6

- Soft-square design
- Dual flush
- Mechanical actuation
- Actuation force < 20N



Oleas™ M4

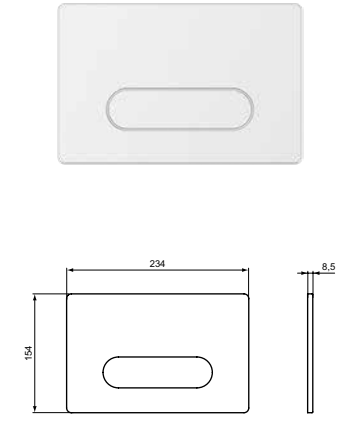

Model	Ref
M4 White	R0126AC
M4 Chrome	R0126AA
M4 Matt Chrome	R0126JG

- Round design
- Single flush
- Mechanical actuation
- Actuation force < 20N

Technical information

Flush plates



Oleas™ P1

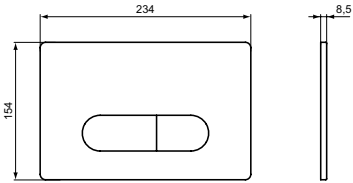

Model	Ref
P1 White	R0116AC
P1 Chrome	R0116AA
P1 Matt Chrome	R0116JG

- Round design
- Dual flush
- Pneumatic actuation
- Actuation force < 20N



Oleas™ P2

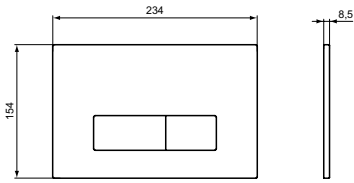

Model	Ref
P2 White	R0119AC
P2 Chrome	R0119AA
P2 Matt Chrome	R0119JG

- Square design
- Dual flush
- Pneumatic actuation
- Actuation force < 20N



Oleas™ P3

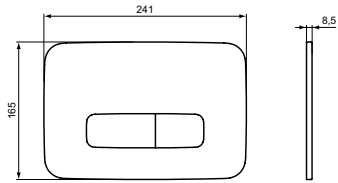

Model	Ref
P3 White	R0124AC
P3 Chrome	R0124AA
P3 Matt Chrome	R0124JG

- Soft-square design
- Dual flush
- Pneumatic actuation
- Actuation force < 20N



Solea™ M1

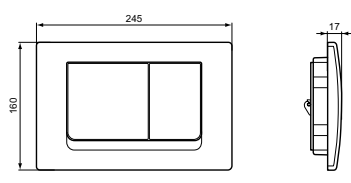
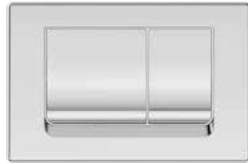

Model	Ref
M1 White	R0108AC
M1 Chrome	R0108AA

- ABS material
- Dual flush
- Mechanical actuation
- Actuation force < 20N



Solea™ M2

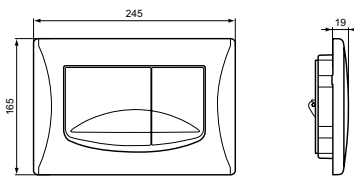

Model	Ref
M2 White	R0109AC
M2 Chrome	R0109AA

- ABS material
- Dual flush
- Mechanical actuation
- Actuation force < 20N



Solea™ P1

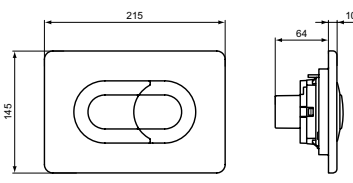
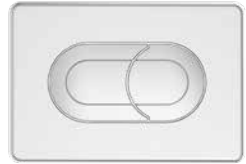

Model	Ref
P1 White	R0133AC
P1 Chrome	R0133AA
P1 Matt Chrome	R0133JG

- ABS material
- Dual flush
- Pneumatic actuation
- Actuation force < 20N

Technical information

Flush plates



Solea™ P2

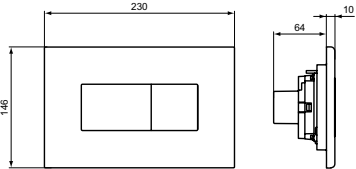
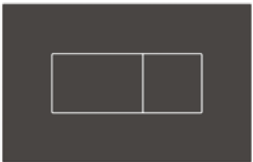

Model	Ref
P2 White	R0110AC
P2 Chrome	R0110AA
P2 Matt Chrome	R0110JG
P2 Black Soft-Touch	R0110A6

- ABS material
- Dual flush
- Pneumatic actuation
- Actuation force < 20N



Septa Pro™ E1

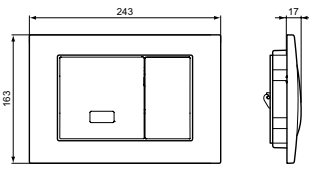

Model	Ref
E1 Chrome	R0131AA

- Zamac material
- Dual flush (< 60s half flush; > 60s full flush)
- Infrared actuation or mechanical actuation (in case of electricity failure)
- Actuation force < 20N
- Flushes are activated when the user moves away
- Automatic
- Pre-installed power supply connection required for transformer
- Transformer 230v/120 included
- Auto flush every 24 hours
- Vandal-resistant



Septa Pro™ E2

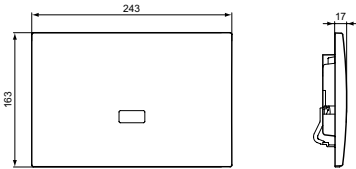
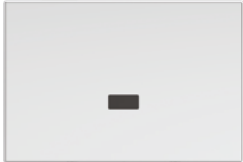

Model	Ref
E2 Chrome	R0132AA

- Zamac material
- Dual flush (< 60s half flush; > 60s full flush)
- Infrared actuation
- Flushes are activated when the user moves away
- Pre-installed power supply connection required for transformer
- Transformer 230v/120 included
- Vandal-resistant



Septa Pro™ M1

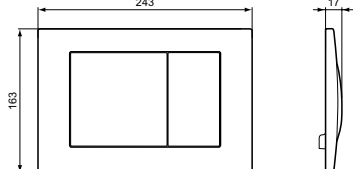
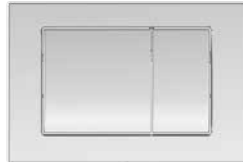

Model	Ref
M1 Chrome	R0127MY

- Zamac material
- Dual flush
- Mechanical actuation
- Actuation force < 20N
- Vandal-resistant



Septa Pro™ M2

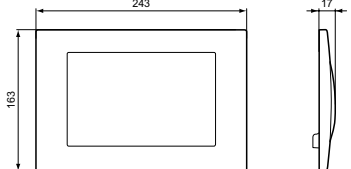
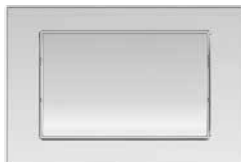

Model	Ref
M2 Chrome	R0128MY

- Zamac material
- Single flush
- Mechanical actuation
- Actuation force < 20N
- Vandal-resistant



Septa Pro™ P1

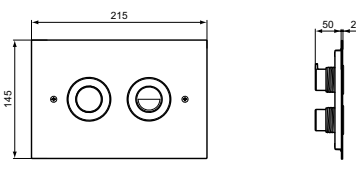

Model	Ref
P1 Chrome	R0188MY

- Stainless steel material
- Dual flush
- Pneumatic actuation
- Actuation force < 20N
- Fixing material and pneumatic pipe not included
- Vandal-resistant

Technical information

Flush plates



Septa Pro™ P2

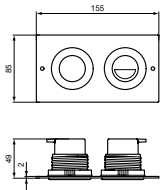
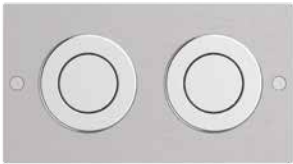

Model	Ref
P2 Chrome	R0134MY

- For remote installation:
- Stainless steel material
 - Dual flush
 - Pneumatic actuation
 - Actuation force < 20N
 - Supplied with fixing material, pneumatic pipe (2,5m) and protective pipe cover (3m)
 - Vandal-resistant
 - Septa Pro inspection plate (separate order) is required to access the cistern



Septa Pro™ P3

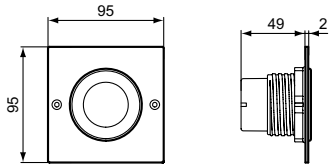

Model	Price
P3 Chrome	XX

- For remote installation:
- Stainless steel material
 - Single flush
 - Pneumatic actuation
 - Actuation force < 20N
 - Supplied with fixing material, pneumatic pipe (2,5m) and protective pipe cover (3m)
 - Vandal-resistant
 - Septa Pro inspection plate (separate order) is required to access the cistern



Septa Pro™ P4

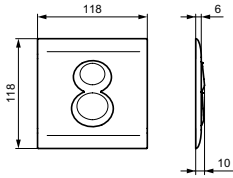

Model	Ref
P4 White	R0136AC
P4 Chrome	R0136AA

- For remote installation:
- ABS material
 - Dual flush
 - Pneumatic actuation
 - Actuation force < 20N
 - Vandal-resistant
 - Compliant with Safety Regulations against Fire and Panic
 - Hazards in Public Buildings (ERP) – Article Co 31.
 - Septa Pro™ inspection plate (separate order) is required to access the cistern

- For remote installation order separately:
- R019667 ProSys™ pneumatic pipe 3m x 2
 - R019767 ProSys™ corrugated pneumatic barrier pipe 1.8m



Septa Pro™ Floor

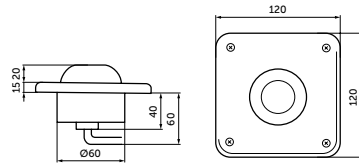

Model	Ref
Stainless Steel	R0138MY

- For remote installation:
- Stainless steel material
 - Single flush
 - Pneumatic actuation foot control
 - Anti-sliding push button
 - Supplied with fixing material, pneumatic pipe (2,5m) and protective pipe cover (2,5m)
 - Vandal-resistant
 - Septa Pro™ inspection plate (separate order) is required to access the cistern



Septa™ XS P1

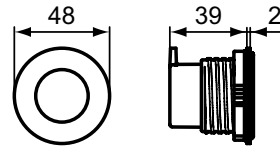

Model	Ref
XS P1 Chrome	P0109AA

- For remote installation:
- ABS material
 - Single flush
 - Pneumatic actuation
 - For light wall installation only
 - Septa Pro™ inspection plate (separate order) is required to access the cistern
- For remote installation order separately:
- R019667 ProSys™ pneumatic pipe 3m x 2
 - R019767 ProSys™ corrugated pneumatic barrier pipe 1.8m



Septa™ XS P2

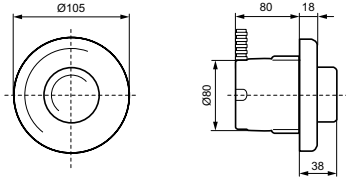

Model	Ref
XS P1 White	R0184AC

- For remote installation:
- ABS material
 - Single flush
 - Pneumatic actuation
 - Supplied with fixing material, pneumatic pipe (2,5m) and protective pipe cover (2,5m)
 - Septa Pro™ inspection plate (separate order) is required to access the cistern

Technical information

Flush Plates



Septa Pro™ Inspection

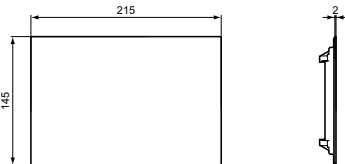

Model	Ref
White Chrome Matt Chrome	R0137AC R0137AA R0137JG

- ABS material for white model
- Stainless steel material for chrome and matt chrome models
- Compatible with all Prosys™ cisterns
- Vandal-resistant



Septa Pro™ U1

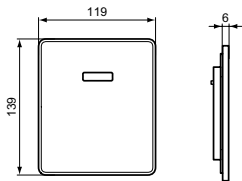

Model	Ref
U1 Chrome	P0114AA

- Stainless steel material
- Double infrared sensor (with automatic setting feature)
- Dynamic sensor: constantly adjusts the optimum range
- Flush time and sensor sensitivity adjustable with touch
- Temporary off for cleaning and short on to trigger a cleaning flush via touch
- 24 or 48 hour auto flush for hygiene
- Vandal-resistant



Septa Pro™ U2

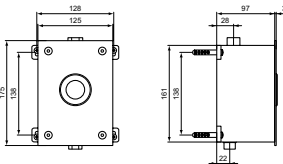

Model	Ref
Stainless Steel	P0115AA

- Zamac material
- Single flush
- Mechanically actuated flush valve
- Adjustable flush time and flow
- Vandal-resistant



SEPTA PRO™ U3

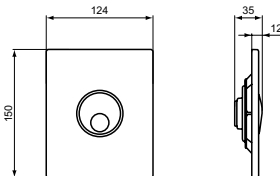

Model	Ref
U3 White U3 Chrome U3 Matt Chrome	R0139AC R0139AA R0139JG

- ABS material
- Single flush
- Mechanically actuated
- Available in three colours
- Flow pressure 0,8 - 5 bar
- Flush volume 0,3 l/s
- Vandal-resistant

Technical information

Accessories



Pneumatic Conversion Kit 120



Model	Ref
Conversion Kit 120 P	R009867

- Conversion from mechanical to pneumatic actuation
- 2 x 350mm pneumatic pipes
- Outlet valve pneumatic anchors
- Pneumatic bellows
- Compatible with ProSys™ 120 cisterns
- Compatible with pneumatic flush plates



Electronic Conversion Kit 120 – Sensor



Model	Ref
Conversion Kit 120 NT S	R015867

- Conversion from mechanical to electronic actuation sensor operated flush plates Symfo™ and Altes™
- Pre-installation of electric connection is needed for connection to mains
- Supplied with transformer to convert mains voltage to extra low voltage for optimum safety
- Compatible with ProSys™ 120 cisterns



Electronic Conversion Kit 120 – Infrared

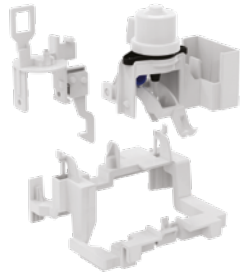

Model	Ref
Conversion Kit 120 NT IR	R009967

- Conversion from mechanical to electronic actuation infrared operated flush plates Septa Pro™ E1 and E2
- Pre-installation of electric connection is needed for connection to mains
- Transformer is supplied with Septa Pro™ E1 and E2 flush plates
- Compatible with ProSys™ 120 cisterns



SmartForce Kit 120



Model	Ref
SmartForce Kit 120	R015767

- Conversion from mechanical to electronic actuation (SmartForce)
- Hydroelectric generator (no connection to mains or replacement of batteries required)
- Storage temperature between: -25° and 65°C
- Degree of protection for the hydroelectric generator: IP67
- Degree of protection for the connection cable: IP67
- Small particle filter integrated in the generator inlet
- Connection to the water supply
- Maximum pressure: < 10bar
- Operating pressure between: 0 and 10bar
- Operating temperature between: -5° and 55°C
- LiFePO4 rechargeable battery with energy management and protection circuit
- Battery capacity: 2750mAh
- Battery supply voltage 6,5Vdc
- 2 pole KCC compatible cables, for power supply and charging
- Compatible with ProSys™ 120 cisterns
- Compatible with no-touch sensor flush plates



Pneumatic Conversion Kit 80



Model	Ref
Conversion Kit 80 P	R014967

- Conversion from mechanical to pneumatic actuation
- 2 x 350mm pneumatic pipes
- Outlet valve pneumatic anchors
- Pneumatic bellows
- Compatible with ProSys™ 80 cisterns



Electronic Conversion Kit 80 – Sensor



Model	Ref
Conversion Kit 80 NT S	R015067

- Conversion from mechanical to electronic actuation (sensor) operated flush plates Symfo™ and Altes™
- Pre-installation of electric connection is needed for connection to mains
- Supplied with transformer to convert mains voltage to extra low voltage for optimum safety
- Automatic flush actuation can be activated
- Flush actuation can be manually deactivated for cleaning
- Protection degree of the sensor: IP67
- Electronic connectors anti-error and waterproof: IP67
- Adjustable detection capacity
- Transformation of mains voltage to extra-low voltage, 4.1 V DC
- Operation with extra-low voltage, no mains voltage in cistern
- User detection range can be set
- Adjustable interval flush
- Compatible with ProSys™ 80 cisterns
- Compatible with no-touch sensor flush plates

Technical information

Accessories



Electronic Conversion Kit 80 – Infrared



Model	Ref
Conversion Kit 80 NT IR	R015167

- Conversion from mechanical to electronic actuation sensor operated flush plates Symfo™ and Altes™
- Pre-installation of electric connection is needed for connection to mains
- Supplied with transformer to convert mains voltage to extra low voltage for optimum safety
- Compatible with ProSys™ 80 cisterns



SmartForce Kit 80



Model	Ref
SmartForce Kit 80	R019167

- Conversion from mechanical to electronic actuation infrared operated flush plates Septa Pro™ E1 and E2
- Pre-installation of electric connection is needed for connection to mains
- Transformer is supplied with Septa Pro™ E1 and E2 flush plates
- Compatible with ProSys™ 80 cisterns



Pneumatic Conversion Kit 150



Model	Ref
Conversion Kit 150 P	R009267

- Conversion from mechanical to pneumatic actuation
- 2 x 350mm pneumatic pipes
- Outlet valve pneumatic anchors
- Pneumatic bellows
- Compatible with ProSys™ 150 cisterns



Top Actuation Conversion Kit 150



Model	Ref
Conversion Kit 150 M T	R017667

- Conversion from mechanical front actuation to top actuation
- Compatible with ProSys™ 150 cisterns
- Compatible with mechanical Oleas™ flush plates



SmartFlush Kit



Model	Ref
SmartFlush Kit	R018667

- Simple refilling system through a control plate of the cistern
- Compatible with ProSys™ 120, 80 and 150 cisterns
- Compatible with Oleas™ SmartFlush flush plates
- Compatible with all the existing detergents on the market (the use of chlorine-free liquid detergents with a viscosity between 150 and 300 cp (at 20°C) is recommended)
- Storage capacity: 450ml

IDEAL STANDARD GULF FZCO
Jebel Ali, Dubai
P.O. Box 261559
United Arab Emirates

Head Offices Dubai tel. +971 4 804 2400
Design Bathroom Centre Dubai tel. +971 4 309 6000
Email: IdealStandardGulf@idealstandard.com

www.idealstandardgulf.com



Part of:
Ideal Standard International Group
(Belgium)



Ideal Standard

www.idealstandardgulf.com

Ideal Standard follows a policy of continuous and consistent improvement on the design and functionality of the products. Thus, it reserves the right to change its manufacturing prescription at any time and discontinue or withdraw any product during the year of validity of this catalogue, without any prior notice.